

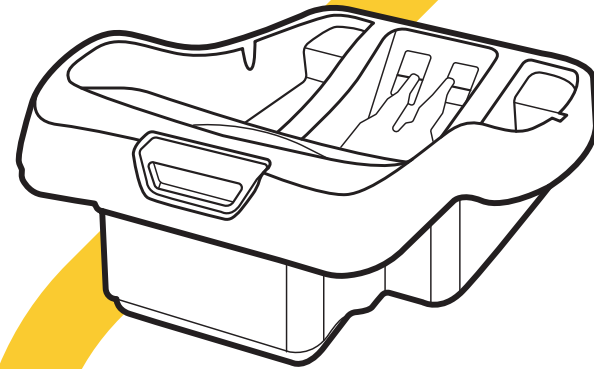

www.safety1st.com

Safety 1st Car Seat Base



KEEP INSTRUCTIONS FOR FUTURE USE.
Read all instructions before
using this car seat base.

WARNING ⚠ Failure to follow the
warnings on the labels and in the
instruction manual can result in
serious injury or death
to your child.



4358-8249

1.4.22

Overview

Welcome to the Safety 1st family and thank you for choosing this car seat base.

This manual will explain how to properly use and install the base that is to be used with a compatible car seat carrier, also known as a child restraint.

For important carrier use and install information, refer to the instruction manual that came with your compatible child restraint.

Your child's safety is worth the time it will take to read and follow these instructions.

Ready? Let's go!

Page 1 will introduce you to the parts of the base.

Page 27 has our contact information. If at any point you would like assistance, please feel free to reach out to us.

Quick Navigation



REAR-FACING

You must follow the weight and height ranges called out in the instruction manual that came with your compatible car seat.

PAGE 2



Vehicle Belt
PAGE 13



Lower
Anchor Belt
PAGE 16

Contents

Getting Started	
Parts of Base	1
Rear-Facing Use Requirements	2
Adjusting Base (On Select Models)	4
Choosing LATCH or Vehicle Belt	
LATCH: Lower Anchor Use	5
Vehicle Belts	7
Rear-Facing Use with Base	11
Vehicle Belt Install	13
LATCH: Lower Anchor Belt Install	16
Safety Information	
Replacement and Expiration of Car Seat	20
Child Restraint Use	21
Installation in Vehicle	21
Vehicle Seating Position	22
Registration and Safety Notices	23
Additional Information	
Warranty	24
Replacement Parts List	26
Dorel Juvenile Group Information	27

Parts of Base

1

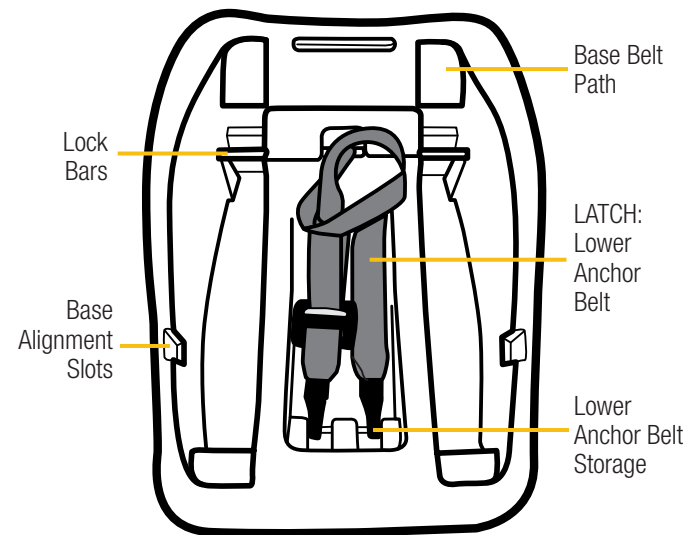

 **This base and compatible car seat can only be used Rear-Facing.**

Your child's height, weight, and age determine how the car seat should be placed in the vehicle.

Children vary widely in body size, shape, and temperament—**please consult your doctor before switching between any types or modes of a car seat within the limits and fit requirements of the car seat.**

State Laws

Please be certain to follow your state's laws regarding car seat use.

American Academy of Pediatrics Recommendations

Infants and Toddlers

Should ride in a rear-facing car seat as long as possible, until they reach the highest weight or height allowed by their seat.

Toddlers and Preschoolers

Once they are facing forward, children should use a forward-facing car seat with a harness for as long as possible, until they reach the height and weight limits for their seats.

School-Aged Children

Once they have outgrown their forward-facing car seat, children should use a belt-positioning booster seat until the vehicle's lap and shoulder seat belt fits properly.

This is often when they have reached at least 4 feet 9 inches in height and are 8 to 12 years old.

Older Children

All children younger than 13 years should be restrained in the rear seats of vehicles for optimal protection.



REAR-FACING

You must follow the weight and height ranges called out in the instruction manual that came with your compatible car seat.

If your child does not meet the criteria in the car seat instruction manual, **do not** use this base or the car seat.

Depending on your model, you may have an adjustable base.

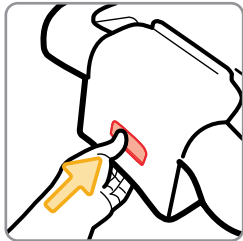

To Lower Base Foot

Push in on the foot release button and pull the foot all the way down.

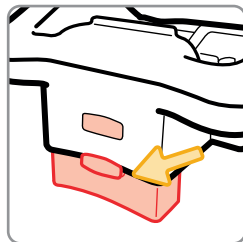
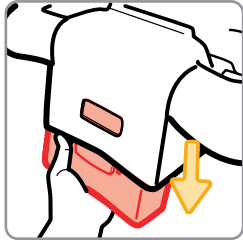

Lock the foot on the release button as shown.



To Store Base Foot

Pull the foot down and press in on the release button.

Push the foot up into the base to the locked position.

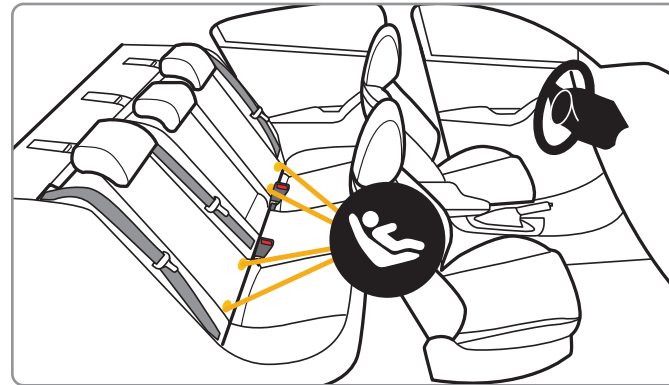

Your vehicle's features may be considerably different than those pictured here.

The lower anchors of **LATCH** (Lower Anchors and Tethers for Children) is a universal system for installing car seats without using vehicle seat belts.

The LATCH: lower anchor belt can **only** be used in vehicles that have the lower anchor bars installed in designated seating positions. Most vehicles manufactured after September 2002 are equipped with LATCH: lower anchor bars.

Check your vehicle owner's manual to see which seating positions may be equipped with LATCH: lower anchor bars.

⚠ Do not use both the lower anchor belt and vehicle belt at the same time.

continued on next page

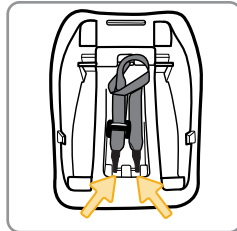

Lower Anchor Belt
Storage Attachments

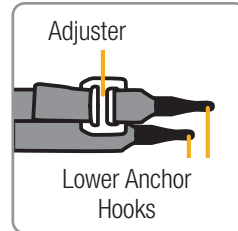

Adjuster
Lower Anchor
Belt Parts

To Remove Lower Anchor Belt from Storage Attachment on Base

Squeeze the spring lever on the hooks and remove the hooks from the storage attachments.

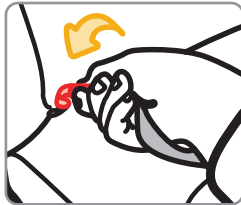

To Remove Lower Anchor Belt from Vehicle's Lower Anchor Bars

Remove the tension from the belt by pushing down on the side of the base with the adjuster. Then press the adjuster's button to loosen the belt.

Remove the hook from the anchor by squeezing the spring lever on the hook, pushing the hook back into the seat bight, and rotating the hook to the side. Then pull the hook out of the vehicle seat bight.

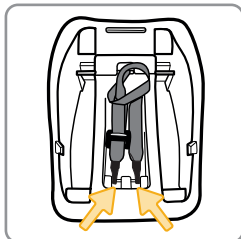

Lower Anchor Belt
Storage Attachments

To Store Lower Anchor Belt

When using the vehicle belts to install or when the base is not installed in a vehicle, the lower anchor belt must be properly stored.

Attach the hooks to the storage attachments in the base.

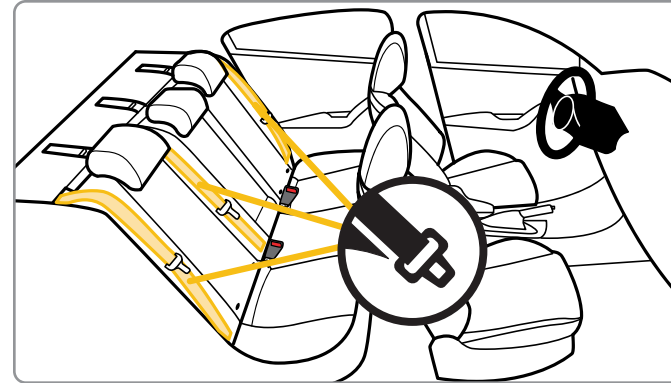

Your vehicle's features may be considerably different than those pictured here.

If LATCH: lower anchors are not an option, you must use the vehicle seat belt system to install the car seat.

Not all vehicle belts and seating positions will work with car seats.

Please go through the following steps to understand how to lock a car seat with a vehicle belt.

continued on next page



1

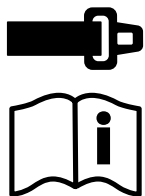

You Must Review Your Vehicle Owner's Manual

Your vehicle owner's manual will let you know which vehicle belts and seating positions car seats can be installed in.

2



Check How This Car Seat Will Be Locked Into Place

The vehicle belt **must not** loosen after tightening. This means there needs to be a way to lock the vehicle belt.

The ways this can be done are:

- By using the seat belt's retractor, see step 3; **OR**
- By using the seat belt's latch plate, see step 4.

3

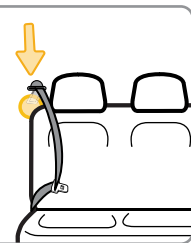

Check Retractor

Retractors pull seat belts into stored positions and lock the belt to hold passengers in place.

See the next page for some common types of vehicle belt retractors that will work with this car seat.



Types of Retractors

Switchable Retractor (most vehicles have this type)



This retractor can be switched to a locking mode.

You **must have the retractor in the locking mode** to use the seat belt with this car seat.

Switching to locking mode: Slowly pull the shoulder belt all the way out, then let it go back in **1-2 in.** (2.5-5 cm).

As it goes back in, you will most likely hear a ratcheting sound.

Gently pull the belt to see if it has locked. You will not be able to pull any more belt out if the lock has engaged.

Automatic Locking Retractor



This retractor always locks.

It will automatically lock after slowly pulling the seat belt out at least halfway and letting the belt go back into the retractor **1-2 in.** (2.5-5 cm).

Emergency Locking Retractor

See Step 4, "Check Latch Plates".

If the retractor does not lock, it is most likely an Emergency Locking Retractor. These retractors only lock during a sudden stop or collision.

You will need to determine if your seat belt's latch plate can lock the belt. See step 4, "Check Latch Plates".

continued on next page

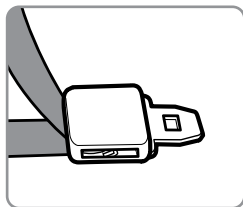
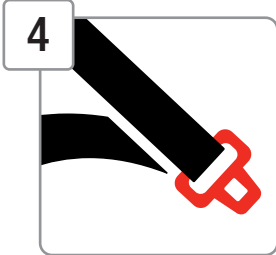

Locking Latch Plate

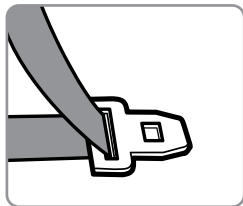

Emergency Locking Retractor with a Sliding Latch Plate

Check Latch Plates

Latch plates are the part of the seat belt that goes into the buckle.

To see if the latch plate locks:

1. Buckle Vehicle Belt
2. Firmly Tug Lap Portion of Seat Belt While Pulling It Up

If the vehicle belt does not slide through the latch plate, it's locked.

If the latch plate slides up and down the vehicle belt, it is a **sliding latch plate**.

Sliding latch plates easily slip between the lap and shoulder portions of the belt.

If you have an Emergency Locking Retractor with a Sliding Latch Plate, you must use a locking clip.

Please contact us for one, see page 26.

Never Use With This Car Seat

Emergency Locking Retractor Lap Only Belt	✗
Inflatable Seat Belts	✗

You must follow the weight and height ranges called out in the instruction manual that came with your compatible car seat.

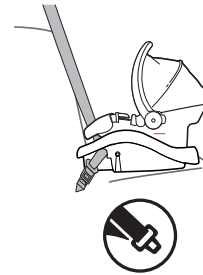

Lap/Shoulder Belt

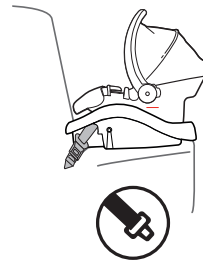

Lap Belt

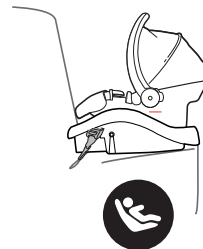

LATCH: Lower Anchor Belt

continued on next page



 Never install a rear-facing child restraint in the front seat of a vehicle equipped with an active frontal airbag.

Do not use the lower anchor belt along with the vehicle lap or lap/shoulder belt.

Check the vehicle belt or the lower anchor belt before each use. Use only if the belt can be tightened properly and locked securely in place.

Do not fasten multiple lower anchor hooks on the same lower anchor bar in the vehicle.

The child restraint must be securely attached to the base.

Even when unoccupied, this child restraint must be firmly secured to the vehicle with a lower anchor belt or with the vehicle seat belt.

This child restraint must always face the rear of the vehicle.



Before you begin installing the base into your vehicle, did you check:

Your child's weight and height?

Refer to the instruction manual that came with your compatible car seat

Your child's fit?

Refer to the instruction manual that came with your compatible car seat.

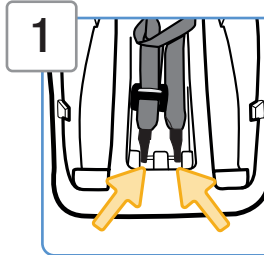

1 Store Lower Anchor Belt

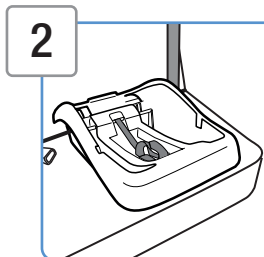

2 Place Base **Rear-Facing** in Vehicle

Center the base in the chosen seating position.

continued on next page



3

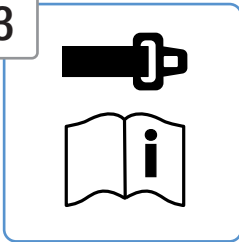

Check if Your Vehicle Belts Will Work With This Car Seat

This is very important because **not all vehicle belts will work with car seats.**

Review pages 7-10 and your vehicle owner's manual to find out what kind of vehicle belts you have and how to lock a car seat in place.

4

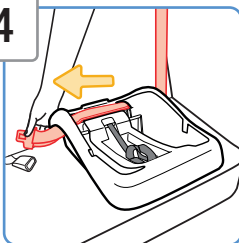

Route Vehicle Lap or Lap/Shoulder Belt Through Base Belt Path

5

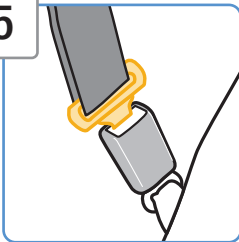

Buckle Vehicle Belt

If your car's vehicle belt has a switchable retractor, use it to lock the vehicle belt.

For information about switchable retractors, see page 9 or review your vehicle owner's manual.

6

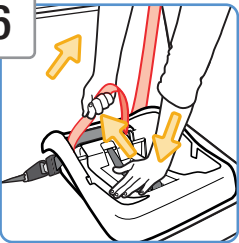

Tighten Belt

Place your hand in the base. Firmly push the base down and back towards the vehicle seat back while pulling the shoulder belt or the free end of the lap belt to tighten.



7

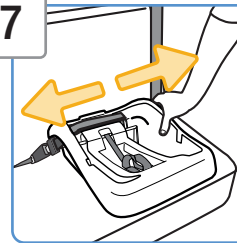

Check Belt Tightness

Hold the base at the **Rear-Facing Belt Path** with your weaker hand.

Push and pull the base from side to side. It should not move more than **1 in.** (2.5 cm).

If it moves more than 1 in. (2.5 cm), you can try:

- Pulling the belt tighter; **OR**
- Reinstalling the base; **OR**
- Changing to a different seating location; **OR**
- Switching to LATCH: lower anchor belt installation if lower anchors are available in your vehicle

Finished!

Check the tightness of the install often to make sure it has not loosened.

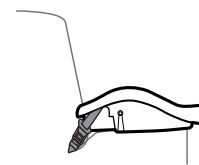



Before you begin installing the base into your vehicle, did you check:

Your child's weight and height?

Refer to the instruction manual that came with your compatible car seat

Your child's fit?

Refer to the instruction manual that came with your compatible car seat.

1

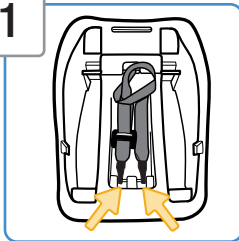

Remove Lower Anchor Belt from Storage Attachments

2

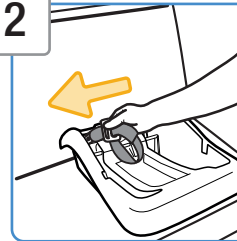

Route Lower Anchor Belt Through Base Belt Path

The adjuster can be on either side of the car seat.

Do not twist belt.

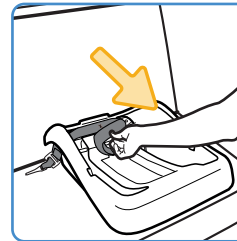

3

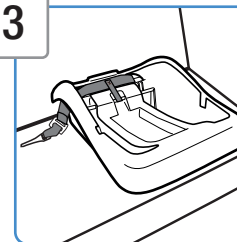

Place Base Rear-Facing in Back Seat

Center the base between the vehicle's lower anchors in the chosen seating position.





4

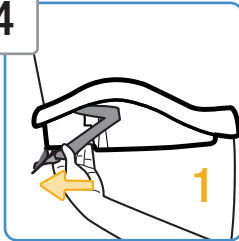

Attach Lower Anchor Hooks to Vehicle's Lower Anchors in Seat Bight

Review your vehicle owner's manual for LATCH: lower anchor locations and lower anchor belt use.

Fasten one hook to one vehicle lower anchor bar.



Then repeat for the second hook on the other side of the base.

5

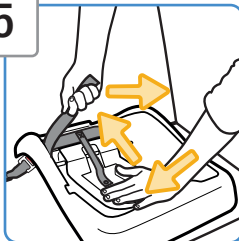

Tighten Belt

Place your hand in the base.

Firmly push the base down and back towards the vehicle seat back while pulling the free end of the belt parallel with the **Rear-Facing Belt Path**.



6

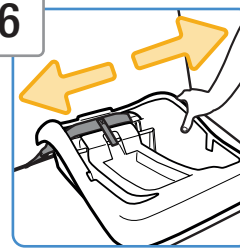

Check Belt Tightness

Hold the base at the **Rear-Facing Belt Path** with your weaker hand.

Push and pull the base from side to side. It should not move more than **1 in. (2.5 cm)**.

If it moves more than 1 in. (2.5 cm), you can try:

- Pulling the belt tighter; **OR**
- Reinstalling the base; **OR**
- Changing to a different seating location; **OR**
- Switching to vehicle belt installation

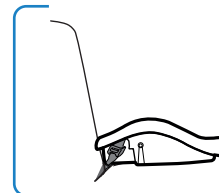

Finished!

Check the tightness of the install often to make sure it has not loosened.

Replacement and Expiration of Car Seat

Do not risk your child's safety.

To keep your child as safe as possible, Dorel Juvenile Group strongly recommends replacing the car seat even after a minor crash; even if it was not occupied at the time.

Replacement After a Minor Crash

The National Highway Traffic Safety Administration states that for a crash to be considered minor **ALL of the following must be true:**

- Vehicle able to drive away from the crash site; **AND**
- Vehicle door nearest the car seat was not damaged; **AND**
- No passengers were injured; **AND**
- Airbags did not deploy; **AND**
- There is no visible damage to the car seat.

If the crash your car seat was involved in meets **ALL** the criteria, you may not need to replace the car seat.

If one or more of these criteria are not true or if you are uncertain of any of your answers, replace the car seat immediately.

Replacement After a Moderate to Severe Crash

You **must** replace this car seat if it has been in a moderate to severe car crash.

This car seat is intended to protect a child in a single crash. During a crash, the car seat and all of its parts absorb crash energy which can deform or weaken it. Damage is not always visible. A damaged car seat must be replaced immediately.

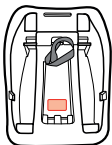

Expiration

Do not use this base more than 8 years after the date of manufacture.

You will find the manufacture date on the label located on the top of the base.



Child Restraint Use

Never take your child out of the child restraint while the vehicle is moving.

Never leave your child unattended. Placing your child in a hot child restraint may result in burns.

Do not use a child restraint with damaged or missing parts.

Do not use a child restraint with cut, frayed or damaged harnesses.

Do not substitute parts or try to modify the child restraint in any way. Do not lubricate buckles and fasteners.

Do not use any child restraint accessory except those approved by Dorel Juvenile Group.

Never allow any child to play with this child restraint; it is not a toy.

Do not remove or cover up any of the warning labels or other labels on the child restraint.

This child restraint has been certified for use in passenger vehicles. Do not use in a boat, on a motorcycle or in a cargo van or bus where there are no seat belts.

Read all instructions for additional warnings.

Installation in Vehicle

Check the vehicle belt or lower anchor belt before each use. Use only if the belt can be tightened properly and locked securely in place.

Even when unoccupied, this child restraint must be firmly secured to the vehicle with a lower anchor belt or with the vehicle seat belt. In a crash or sudden stop, an unsecured child restraint could injure occupants.



Vehicle Seating Position



Never place a child rear-facing in a seating position with an active frontal air bag.



Check the vehicle owner's manual for more information about air bag/child restraint use.



Use the child restraint only on vehicle seats that face forward.

Do not use on seats that face the sides or rear of the vehicle.

For vehicles without a back seat, refer to your vehicle owner's manual.



Children are safer when properly restrained in rear seating positions than in the front seating positions.

According to accident statistics, children in rear seating positions are statistically safer, whether you have air bags, advanced air bags, or no air bags at all.

If you are not sure where to place the car seat in your vehicle: consult your vehicle owner's manual, contact Dorel Juvenile Group Consumer Care Department or visit your local Child Passenger Inspection Station.

Go to <http://www.safercar.gov/cpsApp/cps/index.htm> to find your closest station.

To avoid your child being seriously burned, take the following precautions:

- Park in the shade or where sun does not directly hit the car seat.
- Cover the car seat with a sheet or blanket when not in use.
- Check for hot seat and buckles before placing child in car seat.

To help protect your vehicle seat's upholstery from damage, use a single layer towel underneath and behind car seat.



Please complete the postage-paid registration card that came with your child restraint, and send it to us. Child restraints could be recalled for safety reasons. You must register this restraint to be reached in a recall. Send your name, address, e-mail address if available and the restraint's model number and manufacturing date to:

Dorel Juvenile Group

2525 State Street
Columbus, IN 47201

or call 1-800-544-1108 or register online at
www.djgusa.com/registration/carseat/us.

For recall information, call the U.S. Government's Vehicle Safety Hotline at 1-888-327-4236 (TTY: 1-800-424-9153), or go to www.NHTSA.gov.

Consumer: Just fill in your name, address and email. Please print (use dark ink).

Your Name _____

Your Street Address _____

City _____ State _____ Zip Code _____

Email Address (optional) _____

Model Number: AB123CDE

Model Name: S1 CARSEAT

Manufacture Date: 01/22/2015

L#11 B265035



Example of model number, line code, and manufacture date.

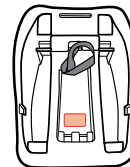

If you don't have the card or if your address changes, you will find the model number, manufacture date, and line code on the label located on the top of the base.

Dorel Juvenile Group, Inc. (DJG) warrants this product to the original retail purchaser as follows: This product is warranted against defective materials or workmanship for one year from the date of original purchase.

An original receipt is required to validate your warranty.

DJG will, at its option, provide replacement parts or replace this product. DJG reserves the right to substitute if the part or model has been discontinued.

To make a claim under this warranty, please contact our Consumer Care Department by phone: 1-800-544-1108 or text: 1-812-652-2525. Our hours of operation are from 8:00 a.m. to 6:00 p.m. EST Monday through Thursday and from 8:00 a.m. to 4:30 p.m. on Friday.

Proof of purchase is required and shipping charges are the responsibility of the consumer.

Warranty Limitations: This warranty does not include damages which arise from misuse or abuse of this product.

Limitation of Damages: The warranty and remedies as set forth are exclusive and in lieu of all others, oral or written, expressed or implied. In no event will DJG or the dealer selling this product be liable to you for any damages, including incidental or consequential damages, arising out of the use or inability to use this product.

Limitation of warranties and other warranty terms and state law rights: Any implied warranties, including implied warranties of the merchantability and fitness for a particular purpose, shall be limited to the duration and terms of the express written warranty.

Some states do not allow limitations as to how long an implied warranty lasts or the exclusion or limitation of incidental or consequential damages, so the above limitations may not apply to you.

This warranty gives you specific legal rights, and you may have other rights, which vary from state to state. Neither DJG nor the dealer selling this product authorized any person to create for it any other warranty, obligation, or liability in connection with this product.

Instructions

**If requested color is not available,
similar color will be substituted.**

**Applicable tax and shipping &
handling will also be added.**

For parts availability and questions,

Call: 1-800-544-1108

Text: 1-812-652-2525

Chat: www.safety1st.com

If you already know which parts you need,
you may complete your order with a credit card
by calling us at 1-800-544-1108.

We accept Visa or MasterCard.

Hours of Operation:

M-TH: 8:00 AM - 6:00 PM EST

FRI: 8:00 AM - 4:30 PM EST

Thank you for choosing this car seat, also known as a child restraint. The DJG family is committed to creating car seats with the most comfort and convenience available today.

Remember, parents are a child's first teachers and examples. If you always buckle your seat belt, your child will think it is the natural thing to do. Make it a firm rule that the vehicle does not go until everyone is buckled up. Make no exceptions.

No one can predict if use of a car seat will prevent injury or death in a particular crash. However, when combined with careful driving, proper use of a car seat can lower a child's risk of injury or death in most crashes.

If you have questions or any concerns with this car seat, please contact our Consumer Care Department:

Call: 1-800-544-1108

Text: 1-812-652-2525

Website: www.safety1st.com

Hours of Operation:

M-TH: 8:00 AM - 6:00 PM EST

FRI: 8:00 AM - 4:30 PM EST