



4358-7157A
3.23.22

Dream Ride® Infant Car Bed

1.8-4.5 kg (4-10 lb) and
61 cm (24 in.) or less

**KEEP INSTRUCTIONS
FOR FUTURE USE.**





Read all instructions
before using this
car bed.



⚠ WARNING:

Failure to read, understand, and follow the instructions and warnings in this instruction manual and the warnings on the system could result in serious injury or death to the infant.

Table of Contents

	Getting Started	1
	Parts of the Car Bed	1
	Securing Infant in Car Bed	3
	Adjusting Buckle	6
	Adjusting Harness Straps	8
	General Use	10
	Carrier Use	10
	Removing Seat Pad for Cleaning	12
	Moving UAS/Vehicle Belt Loops and UAS Belts	14
	Safety Information	18
	Car Bed Use	18
	Installation in Vehicle	19
	Vehicle Seating Position	19
	Transport Canada Regulations	20
	Vehicle Information	21
	Choosing UAS or Vehicle Belts	21
	Knowing Your Vehicle Belts	23
	Aircraft Information	26

	Side Facing	27
---	--------------------------	-----------

	UAS Installation	28
	Vehicle Belt Installation	31

General Information	33
----------------------------------	-----------

Using a Locking Clip	33
Dorel Juvenile Group Information	35
Registration and Safety Notices	36
Warranty	37
Replacement Parts Order Form	38

Parts of the Car Bed

Front View

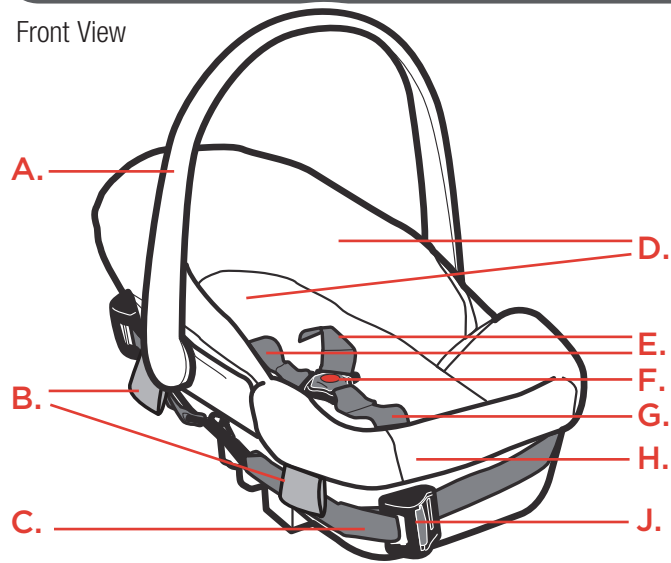

- A.** Carry Handle
- B.** UAS*/Vehicle Belt Loops (2)
- C.** UAS* Belt (2)
- D.** Foam Inserts (under pad)
- E.** Harness Straps
- F.** Buckle
- G.** Buckle Strap
- H.** Buckle Strap Adjustment Slides (under Car Bed)

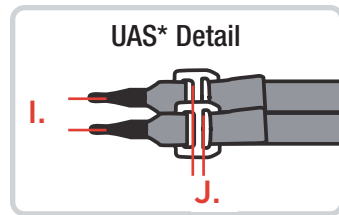

- I.** UAS* Hooks
- J.** UAS* Adjusters

**Universal Anchorage System*

Back View

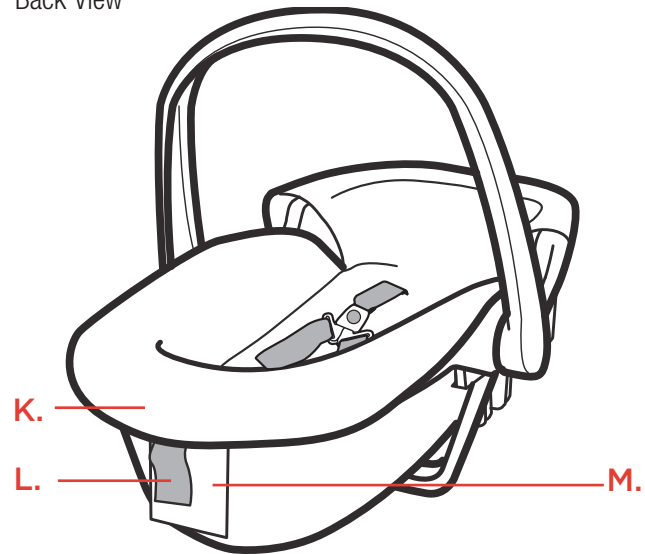

- K.** Harness Adjustment Slides (under pad)
- L.** Harness Strap End
- M.** Instruction Manual Storage



Securing Infant in Car Bed

Always secure infants on their backs unless your doctor advises you to place the infant on their stomach.

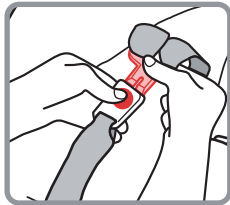

1. Unbuckle Harness

Press in towards the **top** of the red button.

Pull buckle tongues out.

Place harness straps and buckle strap out of the way.

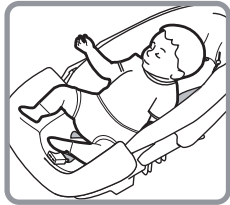

2. Place Infant in Car Bed



3. Position Harness Straps Over the Child's Shoulders

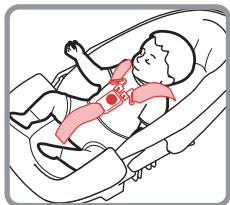

4. Pull Buckle Strap Up Between the Legs

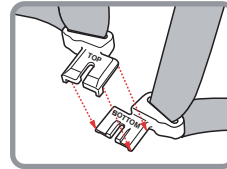

5. Buckle Harness

Fit top buckle tongue over bottom buckle tongue.

Hold buckle tongue with one hand and buckle with the other.

Push buckle tongues into buckle until you hear a "click."

Pull up on harness straps to make sure buckle is locked.

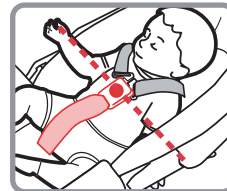
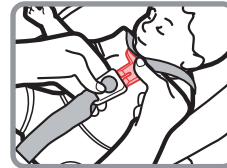

6. Check Harness and Buckle Strap Lengths

The buckle should lay at mid-chest (even with armpits) and away from the infant's neck.

Try to pinch the harness at the shoulders vertically between index finger and thumb as shown.

If your fingers slip off, the harness is tight enough.

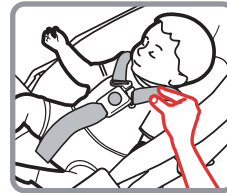

If you can pinch the harness strap, you will need to tighten the harness strap. The harness straps should be snug throughout their length.

Adjusting Buckle



A snug strap should not allow any slack. It lies in a relatively straight line without sagging. It does not press on the child's flesh or push the child's body into an unnatural position.

To adjust the buckle, see pages 6-7.

To adjust the harness straps, see pages 8-9.

⚠ WARNINGS: Failure to fasten and tighten the harness system correctly may allow the child to be ejected from the car bed in a crash or sudden stop causing serious injury or death.



Do not mistake comfort for safety. Harness system must be snugly adjusted.

DO NOT put snowsuits or bulky garments on your child when placing them in the car bed.

Bulky clothing can prevent the harness straps from being tightened properly.

To Remove Infant From Car Bed:

1. Unbuckle Harness
2. Move Harness Away
3. Remove Infant

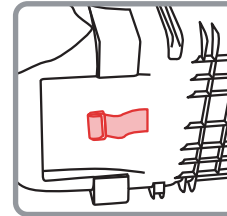

1. Locate Buckle Strap Adjustment Slides on the Bottom of the Shell

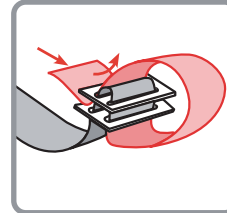

2. Unlace Free End of Buckle Strap from Adjustment Slides

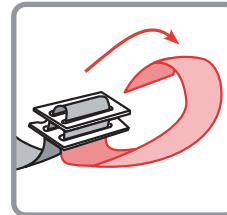

3. To Shorten

Move the adjustment slides closer to shell.

To Lengthen

Move the adjustment slides away from shell.

continued on next page

Adjusting Harness Straps

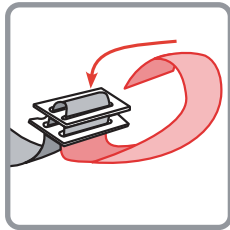

4. Relace Free End of Buckle Strap Between Slides as Shown

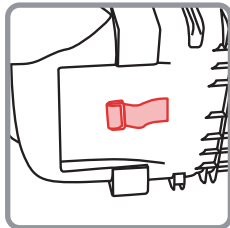
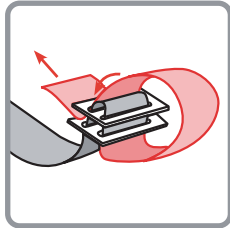

5. Pull Buckle Strap Tight so Adjustment Slides are Flush Against the Shell

⚠ WARNING: Failure to reattach the buckle strap correctly can result in serious injury or death.

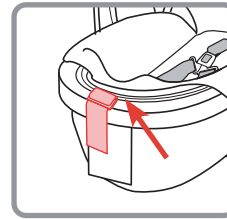

1. Locate Harness Strap Adjustment Slides Under the Pad

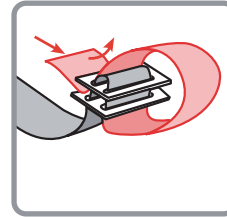

2. Unlace Free End of Harness Strap from Adjustment Slides as Shown

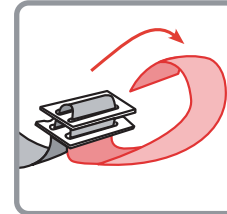

3. To Shorten

Move the adjustment slides closer to shell.

To Lengthen

Move the adjustment slides away from shell.

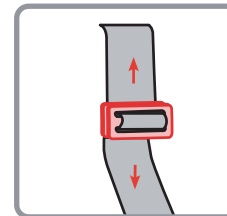

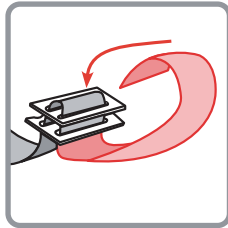

4. Relace Free End of Harness Strap Between Slides as Shown

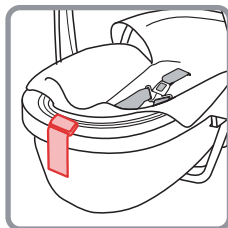
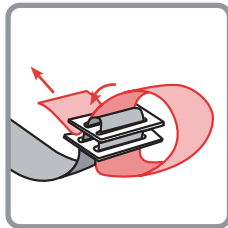

5. Pull Harness Strap Tight so Adjustment Slides are Flush Against the Shell

⚠ WARNING: Failure to reattach the harness strap correctly can result in serious injury or death.

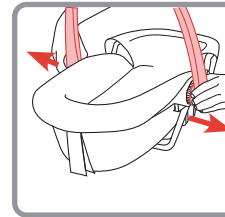

To Adjust Carrying Handle

Pull handle out from shell on both sides. Rotate up or down to desired location. Make sure both sides of handle are locked before using.

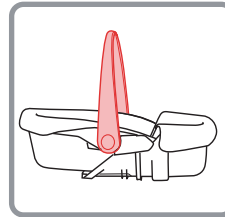

Carry handle **MUST be upright AND locked when carrying and when installed in the vehicle.**

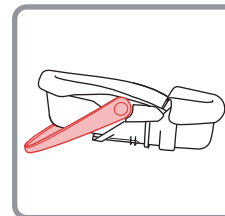

Rocker

Rotate the handle all the way back to put the seat in the rocking mode.

Do **NOT** use this position when installed in the vehicle.

Removing Seat Pad for Cleaning



⚠ WARNINGS:

Read ALL instructions before using car bed as a carrier.

NEVER use carrier unless child is properly secured.

Use only as a carrier by children weighing 1.8-4.5 kg (4-10 pounds) and 61 cm (24 inches) or less.

NEVER leave child unattended. Always keep child within arm's reach.

Suffocation Hazard: Infant carrier can roll over on soft surfaces and suffocate child. **NEVER** place carrier on beds, sofas or other soft surfaces.

Strangulation Hazard: Children have **STRANGLED** in loose or partially buckled harness straps. Fully restrain the child even when carrier is used outside the vehicle.

Fall Hazard: Child's movement can slide carrier. **NEVER** place carrier near edges of counter tops, tables or other elevated surfaces.

Do not use the carrier if it is damaged or broken, or if any parts are missing.

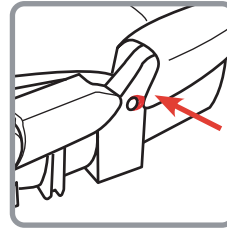

1. Release Elastic Straps from Plastic Button on Each Side of Shell



2. Pull Pad Off Top of Shell



3. Push Buckle Tongues Through Pad

Moving UAS/Vehicle Belt Loops and UAS Belts

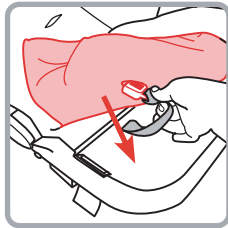

4. Pull Pad Off Bottom of Shell

Pull buckle through pad.
Remove pad.

⚠ WARNINGS: Do not use the car bed without the seat pad or foam inserts.

Failure to do this can result in serious injury or death.

Cleaning Pad

Machine wash separately with cold water on a gentle cycle. Do not use bleach. Tumble dry separately for 10-12 minutes on low heat. Remove immediately.

Cleaning Harness Straps, UAS Belts, UAS/Vehicle Belt Loops

Spot clean using warm sudsy water and damp cloth.

Replace Pad

Place foam inserts in shell if they have been removed. Starting from bottom of car bed, slip pad on shell. Pull buckle through pad. Pull buckle tongues through pad and wrap pad around top of shell. Make sure harness and buckle straps are not twisted. Reattach elastic to plastic buttons on sides of shell.

If needed, the UAS/Vehicle belt loops can be moved to either side of the car bed.

Both belt loops must be on the same side as vehicle seat back.

The UAS belt and UAS/Vehicle belt loops **CANNOT** be threaded into the same slots in the shell. When you move the belt loops, you **MUST** also move the UAS belts.

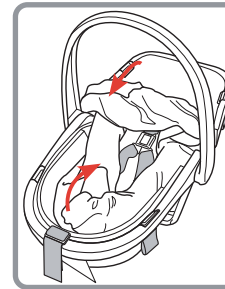

1. Pull Corners of Pad Off Shell

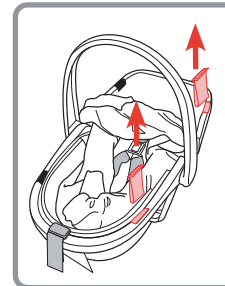

2. Lift Metal Clips Up and Pull Belt Loops Out of Slots in Shell

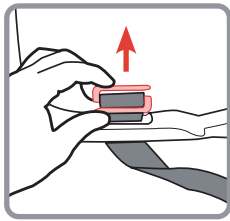

3. Pull "S" Clip and UAS Belt Out of Slots in Shell

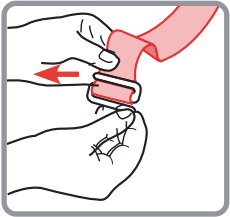

4. Lift Up Inside Corner of "S" Clip
Pull clip and UAS belt away from shell.



5. Unhook UAS Belt Loop from the "S" Clip
Bunch the UAS belt to one side as far as possible.

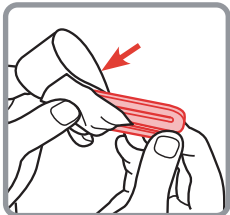

6. Slide Top of Clip Inside the UAS Belt Loop

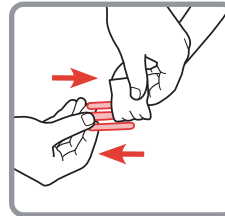

7. Pull "S" Clip Free from UAS Belt Loop
Repeat steps for other UAS belt.

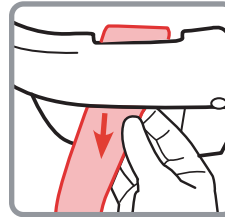

8. Pull UAS Belts Out of Slots

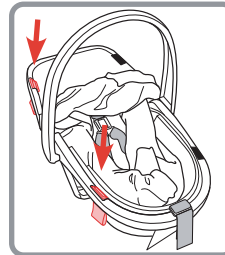

9. Thread UAS/Vehicle Belt Loops into Slots

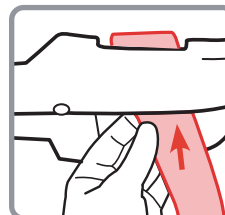

10. Thread UAS Belts into Slots on Opposite Side of Vehicle Belt Loops

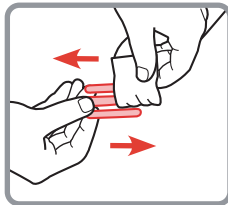

11. Attach “S” Clip to UAS Belt Loop

Insert 2 of the 3 bars on “S” clip into the loop at the end of the UAS belt.

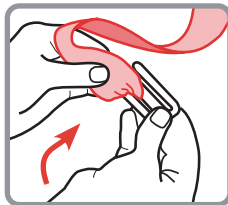

- a. Slide UAS belt loop across the “S” clip until it bunches up on “S” clip and the top bar of “S” clip is free from the UAS belt loop.

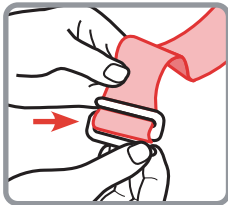

- b. Slide UAS belt loop back across “S” clip until UAS belt loop is centered, making sure top and bottom bar is on the outside of the UAS belt loop.

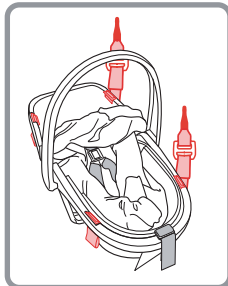

12. Finished

Make sure all metal clips are flush against the shell.

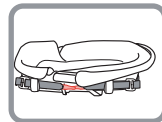

Store UAS as shown when not in use.

Do not use a car bed that has been in a crash or a collision. The car bed must be replaced.

Never take your infant out of the car bed or attend to the infant’s needs while the vehicle is moving.

To avoid the infant being seriously burned, always check for hot seat and buckles before using this restraint system.

Do not use a car bed with missing or damaged parts.

Do not lubricate the buckles, harness system or fasteners for any reason.

Never leave an infant unattended in the car bed.

Do not use a car bed if you do not know the history of the restraint.

DJG does not recommend the use of accessories or add-ons that have not been certified with this car bed at original purchase date.

Never allow anyone to play with this car bed. It is not a toy.

Do not remove the warning labels.

This car bed has been certified for use in passenger vehicles. Do not use in a boat, on a motorcycle or in a cargo van or bus where there are no seat belts or anchors. Do not modify for use as a crib or a swing. Do not leave on stove top or any other hot surface.

On the side of the car bed there is a date of manufacture label. Do not use this car bed more than 8 years after date of manufacture.

Read all instructions and warning labels for additional warnings.



Installation in Vehicle

Check the vehicle belt or UAS belt before each use. Use only if the belt is tightened properly and securely.

When unoccupied the side-facing car bed must be firmly secured to the vehicle with lower universal anchorage system if available or with a vehicle seat belt. In a crash or sudden stop, an unsecured car bed could injure the driver or other occupants in the vehicle.

Always check vehicle owner's manual for proper use of vehicle seat belts and the universal anchorage system (UAS) with your car bed.

In very few vehicles, the car bed cannot be properly installed because of the type of seat belt system or airbag system.

Always read and follow the vehicle owner's manual instructions for child restraint use.

Vehicle Seating Position

Always check vehicle owner's manual for child restraint use with side airbags.

For vehicles with no rear seats, check the vehicle owner's manual for location and installation of a child restraint.



Use the car bed only on vehicle seats that face forward.



Do not use on seats that face the sides or rear of the vehicle.

For vehicles with an airbag, but without a back seat, refer to your vehicle owner's manual.

If you are not sure where to place the car bed in your vehicle, consult your vehicle owner's manual or contact Dorel Juvenile Group Consumer Care Department.



Children are safer when properly restrained in rear seating positions than in front seating positions.

According to accident statistics, children in rear seating positions are statistically safer, whether you have airbags, advanced airbags, or no airbags at all.

To avoid your child being seriously burned, take the following precautions:

1. Park in the shade or where sun does not directly hit the car bed.
2. Cover the car bed with a sheet or blanket when not in use.
3. Check for hot seat and buckles before placing child in car bed.

To help protect your vehicle seat's upholstery from damage, use a single layer towel underneath and behind car bed.

Transport Canada Regulations

Transport Canada Road Safety Directorate regulates children's restraint systems under the Motor Vehicle Restraint Systems Safety Regulations (RSSR).

The regulations require the manufacturer and/or importer to certify the car bed to the applicable safety standards and place specified warnings and information on the labels fastened to each car bed and in this instruction manual.



Choosing UAS or Vehicle Belts

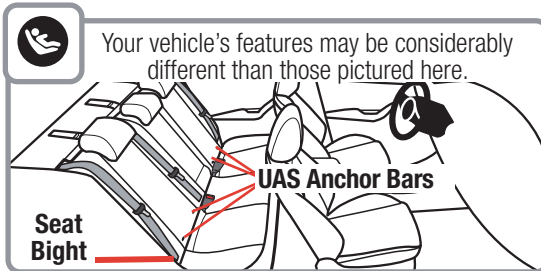

The UAS

The Universal Anchorage System (UAS) is for installing child restraints without using vehicle seat belts.

The UAS can ONLY be used in vehicles that have the UAS anchor bars installed and designated UAS seating positions. Most vehicles manufactured after September 2002 are equipped with UAS. Check your vehicle owner's manual to see which seating positions may be equipped with UAS.

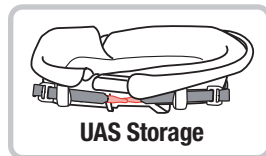
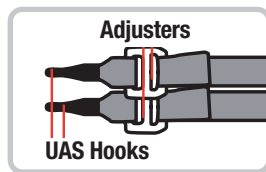

When installing this car bed with vehicle belts, the UAS hooks and belt MUST be properly stored.

Storing UAS Belts: Fully loosen the UAS belts and pull belts around to the opposite side of the shell and attach the hooks together as shown. Gently pull free end of belt to remove slack.

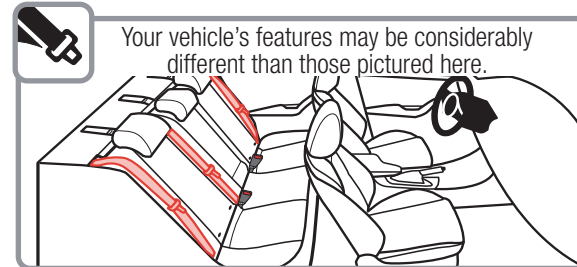

Vehicle Belts

If UAS is not an option, you must use the vehicle seat belt system to install the child restraint.

There are some vehicle belts that will not work with a child restraint or will require special attention. Check your vehicle owner's manual for specific instructions.

⚠ WARNINGS: Do not use both the UAS belt and vehicle belt at the same time.



Knowing Your Vehicle Belts

Not all vehicle belts and seating positions will work with child restraints. Please follow the following steps to understand how to lock a child restraint with a vehicle belt.

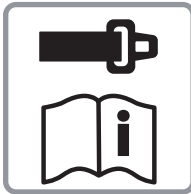

1. You MUST Review Your Vehicle Owner's Manual

Your vehicle owner's manual will let you know what vehicle belts and seating positions child restraints can be installed in.



2. Determine How the Child Restraint Will Be Locked Into Place

The vehicle belt **MUST NOT** loosen after tightening.

This means there needs to be a way to lock the vehicle belt.

The ways this can be done are:

- By using the seat belt's retractor; or
- By using the seat belt's latch plate.

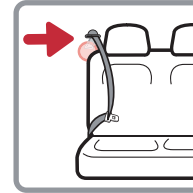

3. Check the Retractor

Retractors pull seat belts into stored positions and lock the belt to hold passengers in place.

A retractor is most likely how you will be locking a child restraint into place.

See below and the next page for some common types of vehicle belt retractors that will work with this child restraint.

Types of Retractors

Switchable Retractor
(most vehicles have this type)



This retractor can be switched to a locking mode.

You **MUST** have the retractor in the locking mode to use the seat belt with this child restraint.

Switching to locking mode: Slowly pull the shoulder belt all the way out, then let it go back in an inch or two. As it goes back in, you will most likely hear a ratcheting sound.

Gently pull the belt to see if it has locked. You will not be able to pull any more belt out if the lock has engaged.

Automatic Locking Retractor



This retractor always locks.

It will automatically lock after slowly pulling the seat belt out at least halfway and letting the belt go back into the retractor an inch or two.

Emergency Locking Retractor

See Step 4, "Check the Latch Plates".

If the retractor does not lock, it is most likely an Emergency Locking Retractor. These retractors only lock during a sudden stop or collision.

You will need to determine if your seat belt's latch plate can lock the belt. See Step 4, "Check the Latch Plates".



4. Check the Latch Plates

Latch plates are the part of the seat belt that goes into the buckle.

Hold the lap belt with one hand and with your other hand grasp the tongue of the latch plate (the part that goes inside the buckle). Pull the latch plate straight out in line with the lap belt.

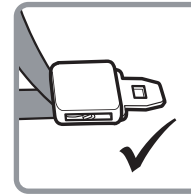

Locking Latch Plate

If the latch plate does not slide up and down the vehicle belt, it is a **locking latch plate**.

If the latch plate slides up and down the vehicle belt, it is a **sliding latch plate**.

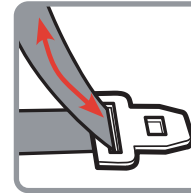

Emergency Locking Retractor with a Sliding Latch Plate

Sliding latch plates easily slip between the lap and shoulder portions of the belt.

If you have an Emergency Locking Retractor with a Sliding Latch Plate, you **MUST** use a locking clip to install the child restraint. See pages 33-34.

Never Use With This Car Bed

Emergency Locking Retractor
Lap Only Belt



Inflatable Seat Belts



Aircraft Information

This car bed is not certified for aircraft use.





1.8-4.5 kg (4-10 lb) and 61 cm (24 in.) or less

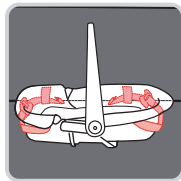

UAS Belt

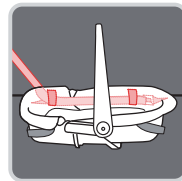

Lap/Shoulder Belt

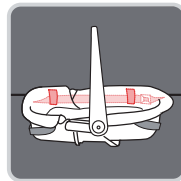

Lap Belt



⚠ WARNINGS: Failure to place this car bed side-facing with the child's head toward center of vehicle seat can result in serious injury or death.

Install side-facing. The back seat is preferred; however, the front passenger seat is acceptable, even with an airbag, as long as the car bed does not interfere with vehicle operation and the passenger seat is moved back as far as possible away from the airbag.

Check vehicle owner's manual for more information about airbag/car bed use.

⚠ WARNINGS: Do not use the UAS along with the vehicle lap or lap/shoulder belt. Check UAS belt before each use. Use only if the belt can be tightened properly and securely.

Do not fasten multiple UAS hooks on the same UAS anchor bar in the vehicle.

Failure to follow these warnings can result in serious injury or death.

1. Thread Left UAS Belt Through Left Belt Loop As Shown

Repeat for right side. Do not twist belt.

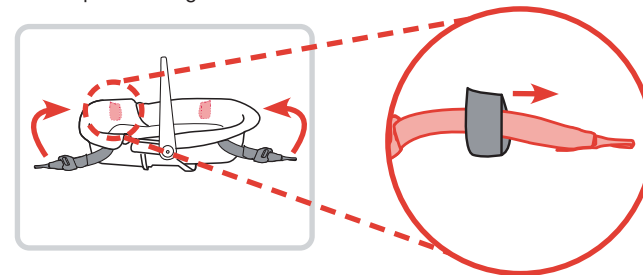

2. Place Car Bed Side Facing in the Back Seat with Child's Head Towards the Center of Vehicle Seat

UAS/Vehicle belt loops must be on the side of the car bed that is against the vehicle seat back as shown.

To move the belt loops and UAS belts, see pages 14-17.

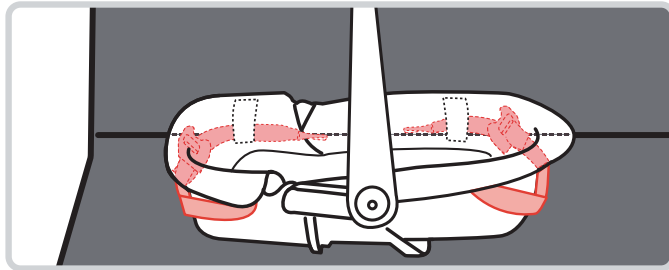

Carry handle **MUST** be upright AND locked when installed in the vehicle.

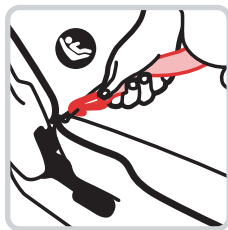

3. Attach UAS Hooks to Vehicle's UAS Anchors

Review your vehicle owner's manual for UAS anchor locations and UAS belt use.

Repeat for other side of car bed.

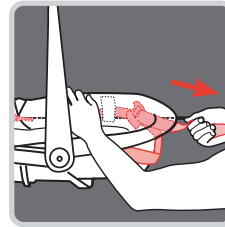

4. Tighten Belt

Lay your forearm across the car bed while pulling up on free end of UAS belt to tighten.

Repeat for other UAS belt.

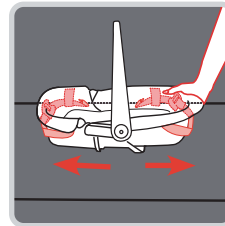

5. Check Belt Tightness

Hold the car bed at the belt path with your weakest hand. Push and pull from side to side.

It should not move more than 2.5 cm (1 in.).

If it moves more than 2.5 cm (1 in.), you can try:

- A.** Pulling the belt tighter.
- B.** Reinstalling the car bed.
- C.** Changing to a different seating location.
- D.** Switching to vehicle belt installation.



Vehicle Belt Installation

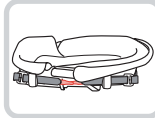

⚠ WARNINGS: Do not use the UAS along with the vehicle lap or lap/shoulder belt. Secure UAS as shown when installing with vehicle belts.

Check vehicle belt before each use.

Use only if the belt can be tightened properly and locked securely in place.

Failure to follow these warnings can result in serious injury or death.

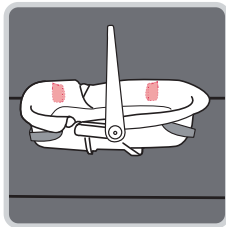

Carry handle **MUST** be upright **AND** locked when installed in the vehicle.

1. Place Car Bed Side Facing in the Back Seat with Child's Head Towards the Center of Vehicle Seat

UAS/Vehicle belt loops must be on the side of the car bed that is against the vehicle seat back as shown.

To move the belt loops and UAS belts, see pages 14-17.

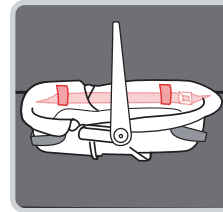

2. Thread Vehicle Belt

Thread the vehicle lap or lap/shoulder belt combination through belt loops as shown.

Review pages 23-26 and your vehicle owner's manual to

determine what kind of vehicle belt you have and how to lock a child restraint in place. Buckle vehicle belt.

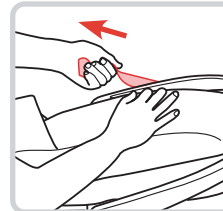

3. Tighten Belt

Lay your forearm across the car bed while pulling up on shoulder belt or free end of lap belt to tighten.

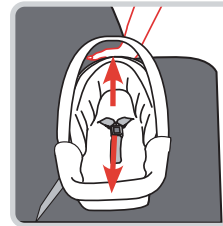

4. Check Belt Tightness

Hold the car bed at the belt path with your weakest hand.

Push and pull from side to side.

It should not move more than 2.5 cm (1 in.).

If it moves more than 2.5 cm (1 in.), you can try:

A. Pulling the belt tighter. **B.** Reinstalling the car bed.
C. Changing to a different seating location. **D.** Switching to UAS installation if UAS anchors are available in your vehicle.



Using a Locking Clip

You will rarely need to use a locking clip except in some older vehicles.

Built-in child restraint locking systems have been required in vehicles since 1996, and many vehicles had these features even earlier. Review pages 23-26 and your vehicle owner's manual to determine if your vehicle belts require a locking clip.

If you need a locking clip immediately, they are likely available at an auto dealership, an auto store, or where you purchased this child restraint. You can also call us at 1-800-544-1108 for one.

A locking clip will not fix all types of seat belt problems. You **MUST** have a lap and shoulder belt to use a locking clip.

For Side Facing installation, follow Pages 31-32 Warnings and Steps 1-3 before starting locking clip installation.

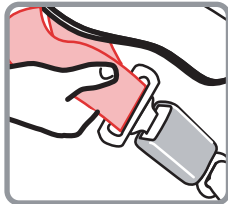

1. Determine Locking Clip Position

Grasp both vehicle belts together just behind the latch plate to mark the position for locking clip.

Unbuckle the belt.

NOTE: If the latch plate ends up just at the belt path opening so you cannot grasp the vehicle belt at the latch plate, grasp the vehicle belts on the opposite side of the car bed, as close to the latch plate as possible.

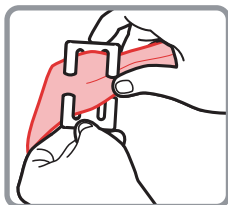

2. Attach Locking Clip

Thread both portions of the vehicle belt onto the locking clip, as close to the latch plate as possible.

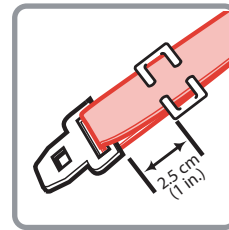

3. Position Locking Clip

It should be about 2.5 cm (1 in.) from vehicle belt's latch plate.

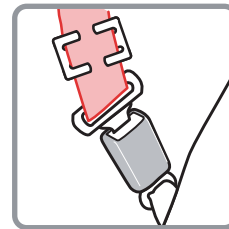

4. Rebuckle Vehicle Belt

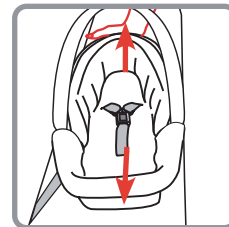

5. Check Belt Tightness

Hold the car bed at the belt path with your weakest hand.

Push and pull from side to side.

If it moves more than 2.5 cm (1 in.), you can try:

A. Pulling the belt tighter.

B. Reinstalling the car bed. **C.** Changing to a different seating location.

Remove the locking clip when the seat belt is not being used with a car bed.

Dorel Juvenile Group Information

Thank you for choosing this car bed. The DJG family is committed to creating child restraints with the most comfort and convenience available today.

Remember, parents are a child's first teachers and examples. If you always buckle your seat belt, your child will think it is the natural thing to do. Make it a firm rule that the vehicle does not go until everyone is buckled up. Make no exceptions.

No one can predict if use of a child restraint will prevent injury or death in a particular crash. However, when combined with careful driving, proper use of a child restraint can lower a child's risk of injury or death in most crashes.

Your child's safety is worth the time it will take to read and follow these instructions. After reading, if you still have questions or have any concerns with this car bed, please contact our Consumer Care Department at:

Website: www.djgusa.com

Telephone: 1-800-544-1108

M-TH from 8 A.M. to 6 P.M. EST
FRI from 8 A.M. to 4:30 P.M. EST

Mailing Address:

Dorel Juvenile Group, Inc.
Consumer Care Department
P.O. Box 2609
Columbus, IN 47202-2609

Registration and Safety Notices

Although car beds are tested, evaluated, and certified by the manufacturer and tested by Transport Canada, it is possible that a safety-related problem may be found. If there is ever a safety issue with your child restraint, we use registration information to reach owners.

Tear Off and Mail This Part or Register Online / Déchirez et postez cette partie ou enregistrez en ligne 4399-4117E

Consumer: Just fill in your name, address and email. Please print.
Client: Simplement inscrire votre nom, adresse et courriel. S.V.P. imprimez.

Your Name/Votre nom: _____
re adresse: _____
provinc _____
Email Address (optional)/Courr _____

Model Number AB123CDE	Line Code Dream Ride Car Bed	Manufacture Date 2015/05/16
Date of Purchase/Date d'achat: _____		L#11 B265035

Example of model number, manufacture date, and line code.

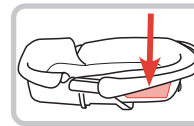

If you don't have the card or if your address changes, you will find the model number, manufacture date, and line code on the label located on side of shell.

There are three additional ways to register your information:

Online: www.djgusa.com/registration/carseat/can

Telephone: 1-800-544-1108

Mail: Send your name, address and your car bed's model number, manufacture date, line code, and date of purchase to:

Dorel Juvenile Canada
2233 Argentia Road, Suite 110
Mississauga, ON L5N 2X7

For information on safety-related problems, you can also call Transport Canada's Road Safety Dept. at: 1-800-333-0371.

Warranty

Dorel Juvenile Group, Inc. (DJG) warrants this product to the original retail purchaser as follows:

This product is warranted against defective materials or workmanship for one year from the date of original purchase. **An original receipt is required to validate your warranty.** DJG will, at its option, provide replacement parts or replace this product. DJG reserves the right to substitute if the part or model has been discontinued.

To make a claim under this warranty you may write to DJG, Consumer Care Department, P. O. Box 2609, Columbus, IN 47202-2609; or call 1-800-544-1108 from 8:00 a.m. to 6:00 p.m. EST Monday through Thursday and from 8:00 a.m. to 4:30 p.m. on Friday.

Proof of purchase is required and shipping charges are the responsibility of the consumer.

Warranty Limitations: This warranty does not include damages which arise from misuse or abuse of this product.

Limitation of Damages: The warranty and remedies as set forth are exclusive and in lieu of all others, oral or written, expressed or implied. In no event will DJG or the dealer selling this product be liable to you for any damages, including incidental or consequential damages, arising out of the use or inability to use this product.

Replacement Parts Order Form

Complete the form. Your model number and manufacture date code **MUST** be included on the form to ensure proper replacement parts. The codes can be found on a label on side of child restraint. Payment in U.S. dollars must accompany your order. Choose parts needed from the list on the next page.

Return the form with payment to:

**Dorel Juvenile Group, Inc.
Consumer Care Department**

P.O. Box 2609
Columbus, IN 47202-2609

Please make money orders payable to Dorel Juvenile Group, Inc. Fill in the area on the next page to charge credit card. (Visa or MasterCard **only**). We do not accept cash, personal checks, or other credit cards. All outside of U.S. and Canada **MUST** use credit card.

Ship To: (Please Print)

Name: _____

Address: _____

City: _____

Province: _____ **Postal Code:** _____

Country: _____

Telephone: _____

Email Address: _____

We **MUST** have this information:

Model Number (8 to 9 characters): _____

Manufacture Date (yyyy/mm/dd): _____

Replacement Parts List

NOTE: If requested color is not available, similar color will be substituted.

Part	Cost	Quantity	Total Cost
Buckle Assembly.....	\$6.99	X _____	= \$ _____
Belt Loop (1)*	\$2.00	X _____	= \$ _____
UAS Belt (1)*	\$4.50	X _____	= \$ _____
Seat Pad	\$19.99	X _____	= \$ _____
Locking Clip	\$2.50	X _____	= \$ _____
"S" Clip (1)*	\$2.00	X _____	= \$ _____
Instructions.....	\$0.00	X _____	= \$ _____

*2 are required to use this car bed

Merchandise Total \$ _____

Shipping and handling: \$ _____

Up to \$25.00	\$5.95	\$100.01 to \$150.00	\$10.95
\$25.01 to \$50.00	\$6.95	\$150.01 to \$200.00	\$11.95
\$50.01 to \$75.00	\$8.95	\$200.01 and up	\$13.95
\$75.01 to \$100.00	\$9.95	Outside Continental USA and Canada	\$10.00

Sales Tax:..... \$ _____

Residents of Quebec, add 5% GST and 9.975 PST%.
 Residents of New Brunswick and Newfoundland and Labrador, add 15% HST.
 Residents of Nova Scotia add 15% HST.
 Residents of Saskatchewan add 5% GST and 5% PST.
 Residents of Manitoba add 5% GST and 8% PST.
 All other Provinces and Territories, add 5% GST.

Grand Total:..... \$ _____

No shipping and handling on instructions for quantities under 6. Add \$.50 for each instruction over 6, then add applicable shipping and handling.

Fill Out For Credit Card
 Visa MasterCard

Card Exp. Date: _____

Cardholder's Name: _____

Card Number: _____

Signature: _____

CUT ON DOTTED LINE