



www.safety1st.com

Grand 2-IN-1 BOOSTER CAR SEAT

Forward-Facing Mode: 30-65 lb (13.6-29 kg)
and 32-49 in. (81.3-125 cm)
and at least 1 year old

Booster Seat Mode: 40-120 lb
(18.1-54.4 kg) and
43-57 in. (110.1-144.8 cm)

**KEEP INSTRUCTIONS FOR FUTURE
USE.** Read all instructions before
using this car seat.

WARNING ⚠ Failure to follow
the warnings on the labels and
in the instruction manual can
result in serious injury or
death to your child.

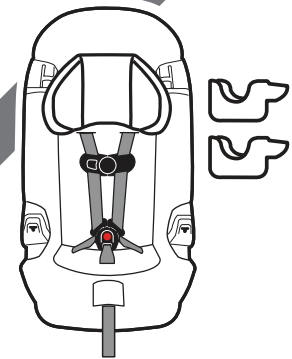

4358-8023A 11.29.21

Overview

Welcome to the Safety 1st family and thank you for choosing this car seat, also known as a child restraint!

To help you get started using your child's new car seat, here are the 4 main tasks you'll need to complete:

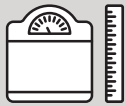

Measure Your Child



Adjust Car Seat to Fit Your Child



Install Car Seat into Your Vehicle



Secure Your Child in Car Seat

Your child's safety is worth the time it will take for you to read and follow these instructions.

Ready? Let's go!

Pages 1-3 will introduce you to the parts of the car seat.

Page 60 has our contact information. If at any point you would like assistance, please feel free to reach out to us.

Quick Navigation

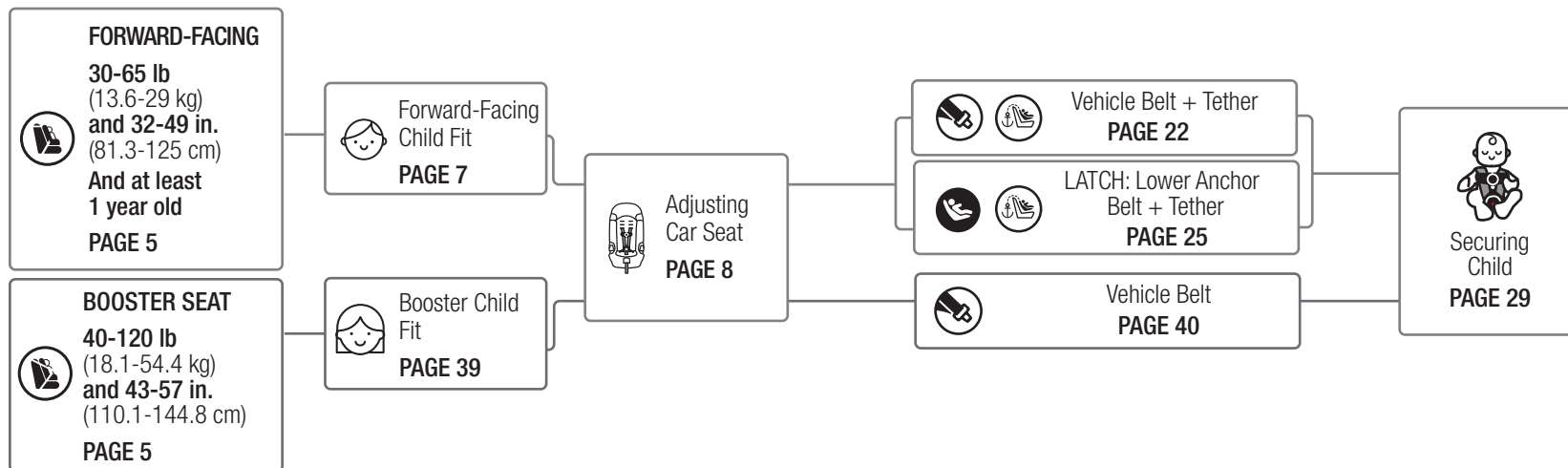

Contents

Getting Started

Parts of Car Seat	1
Accessory Use	3
Choosing Car Seat Mode	4
Preparing Car Seat for Child Fit	6
Forward-Facing Child Fit	7

Making Adjustments to Car Seat

Changing Shoulder Harness Strap Position	8
--	---

Choosing LATCH or Vehicle Belt

LATCH: Lower Anchor Use	10
Vehicle Belts	13
Tether Use	18

Installation in Vehicle

Forward-Facing Mode	20
Forward-Facing Vehicle Belt + Tether Install	22
Forward-Facing LATCH Belt+ Tether Install	25

Securing Child in Car Seat

29

Booster Seat Mode	33
Removing Harness System	35
Storing Harness System	37
Booster Seat Child Fit	39
Lap/Shoulder Belt Use	40

Wash & Care of Car Seat Parts

Removing Seat Pad for Cleaning	42
--------------------------------------	----

Cleaning Parts of Car Seat & Installing Seat Pad Set

43

Safety Information

Aircraft Information	48
Replacement and Expiration of Car Seat	49

Child Restraint Use	51
Installation in Vehicle	52
Vehicle Seating Position	52
Registration and Safety Notices	54

Additional Information

Troubleshooting	56
Warranty	57
Replacement Parts List	59
Dorel Juvenile Group Information	60

Parts of the Car Seat

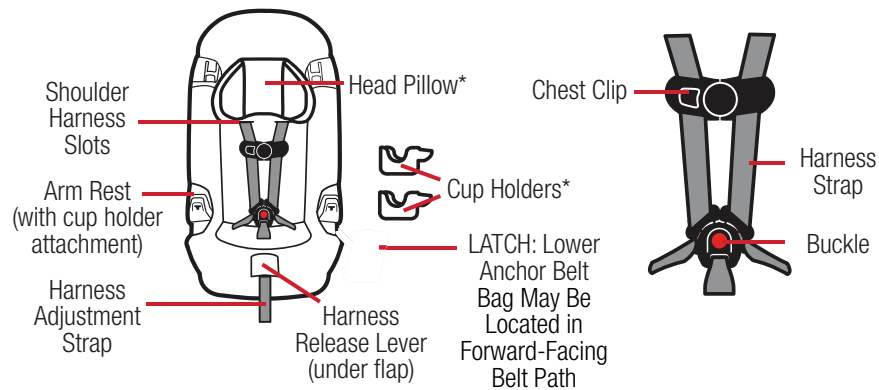

*See page 3 for Accessory Use.

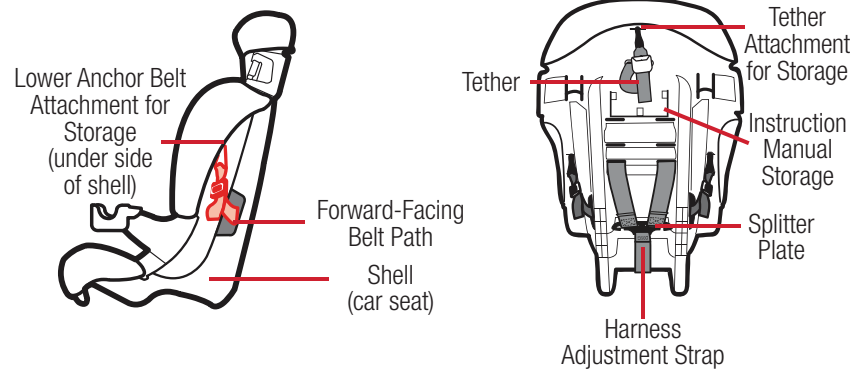

**Head Pillow**

To remove, slide the tabs on the back of the head pillow out of the slots in the seat pad.

To install, slide the tabs on the back of the head pillow into the slots in the seat pad.

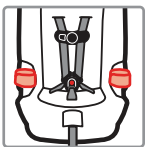
**Cup Holder**

The cup holder is top-rack dishwasher safe.

To attach, push cup holder onto end of armrest (until you hear a click).

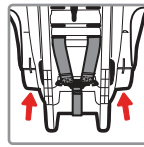

To remove, locate the cup holder tabs on back of the shell.

Push the tab to the side.

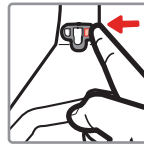

While pushing the tab to the side, pull out the cup holder at an upward angle.



⚠ Measure your child's weight and height (do not guess) before choosing the car seat's mode.

Your child's height, weight, and age determine how the car seat should be placed in the vehicle.

Children vary widely in body size, shape, and temperament—**please consult your doctor before switching between any of these modes within the limits and fit requirements of the seat.**

State Laws: Please be certain to follow your state's laws regarding car seat use.

American Academy of Pediatrics Recommendations

Infants and Toddlers: Should ride in a

rear-facing car seat as long as possible, until they reach the highest weight or height allowed by their seat.

Toddlers and Preschoolers: Once they are facing forward, children should use a forward-facing car seat with a harness for as long as possible, until they reach the height and weight limits for their seats.

School-Aged Children: Once they have outgrown their forward-facing car seat, children should use a belt-positioning booster seat until the vehicle's lap and shoulder seat belt fits properly. This is often when they have reached at least 4 feet 9 inches in height and are 8 to 12 years old.

continued on next page

Older Children: All children younger than 13 years should be restrained in the rear seats of vehicles for optimal protection.

FORWARD-FACING MODE

30-65 lb (13.6-29 kg) and **32-49 in.** (81.3-125 cm)

Children must be at least 1 year of age to ride **Forward-Facing**.

In this car seat, your child can remain harnessed Forward-Facing until they outgrow any one of the following:

- **Weight Limit:** 65 lb (29 kg); **OR**
- **Height Limit:** 49 in. (125 cm); **OR**
- **Forward-Facing Child Fit** requirements, see page 7

BOOSTER SEAT MODE

40-120 lb (18.1-54.4 kg) and **43-57 in.** (110.1-144.8 cm)

Your child can remain in this Booster Seat until they outgrow any one of the following:

- **Weight Limit:** 120 lb (54.4 kg); **OR**
- **Height Limit:** 57 in. (144.8 cm); **OR**
- **Booster Child Fit** requirements, see page 39

Prepare Car Seat to Fit Your Child

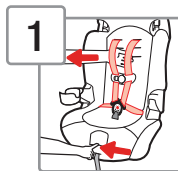

1

Fully Loosen Harness Straps

Push down on the harness release lever (under the flap on the front of the seat pad) while pulling out on the harness straps as shown.

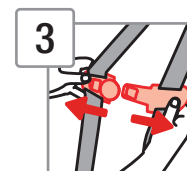

3

Release Chest Clip

Hold each side of the chest clip. Press on the release button with your thumb and pull the chest clip apart.



2

Unbuckle Harness

Press in towards the **top** of the red button to release the buckle tongues.



4

Place Child in Car Seat to Determine Proper Harness Fit

Your child's bottom and back should be flat against the car seat.

For Forward-Facing child fit, see page 7.



Forward-Facing Child Fit



Head Position

The tops of your child's ears **must be below** the top of the car seat.



Buckle Position

The buckle **should not be underneath or behind** your child.

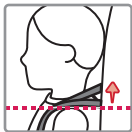

Harness Strap Position

The harness strap **must be at or slightly above** the your child's shoulders; **never below.**

Need to make adjustments?

To change harness strap position, see pages 8-9.

Changing Shoulder Harness Strap Position

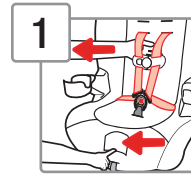

1

Fully Loosen Harness Straps

Push down on the harness release lever (under flap on front of seat pad) while pulling out on the harness straps as shown.



2

From Back of Car Seat, Remove Harness Straps Loops From Splitter Plate

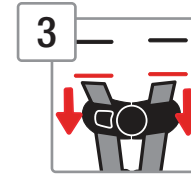

3

Pull Harness Straps Out of Shoulder Harness Slots

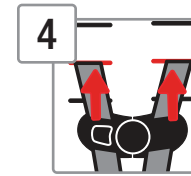

4

Rethread Harness Straps into Correct Shoulder Harness Slots For Your Child

For Forward-Facing child fit, see page 7.

continued on next page

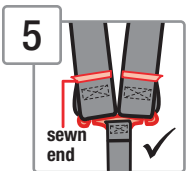

5 Attach Harness Strap Loops to Splitter Plate

Sewn ends of the harness strap loops **must** face towards you.

Do not twist harness straps or harness adjustment strap. Make sure the harness strap loops are fitted **completely on** both sides of the splitter plate.

Check your child's fit often.

To learn how to check harness tightness, see pages 29-32.

Check the harness straps often for any wear or damage.

⚠ Make sure the harness height is correct for your child's size.

Harness system must be installed correctly. Do not use a child restraint with damaged harness straps.



For Use in Forward-Facing Mode

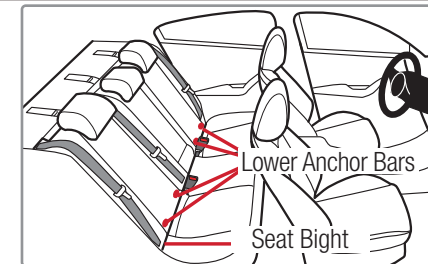

Your vehicle's features may be considerably different than those pictured here.

The lower anchors of **LATCH** (Lower Anchors and Tethers for **CH**ildren) is a universal system for installing car seats without using vehicle seat belts.

The LATCH: lower anchor belt can **only** be used in vehicles that have the lower anchor bars installed in designated seating positions. Most vehicles manufactured after September 2002 are equipped with LATCH: lower anchor bars.

Check your vehicle owner's manual to see which seating positions may be equipped with LATCH: lower anchor bars.

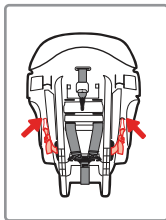
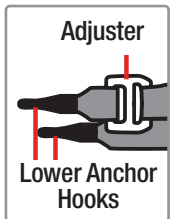

To Remove Lower Anchor Belt from Storage Location on Car Seat:

Squeeze spring lever on hooks and remove hooks from storage attachments.

When installing this car seat with vehicle belts, the lower anchor hooks and belt MUST be properly stored.



Do not use both the lower anchor belt and vehicle belt at the same time.

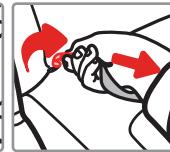
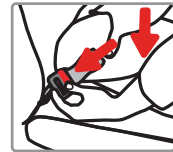

To Remove Lower Anchor Belt from Vehicle Lower Anchor Bars:

Remove tension from the belt by pushing down on side of car seat with the belt adjuster. Then press the adjuster button to loosen belt.

Unhook from anchor by squeezing spring lever

on hook, pushing hook back into the seat bight, and twisting. Then pull it out of the vehicle seat.

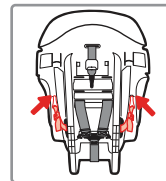

Storing Lower Anchor Belt:

Thread the lower anchor belt through the Forward-Facing belt path. Then attach the hooks to storage attachments, as shown.

Gently pull free end of belt to remove slack.

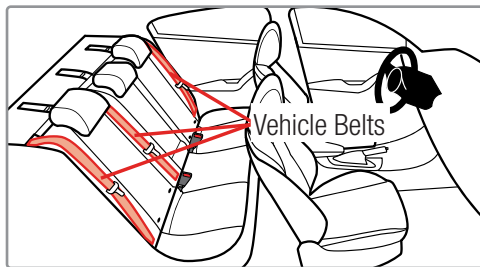

Your vehicle's features may be considerably different than those pictured here.

If lower anchors are not an option, you must use the vehicle seat belt system to install the car seat.

Not all vehicle belts and seating positions will work with child restraints. Please go through the following steps to understand how to lock a child restraint in Forward-Facing Mode with a vehicle belt.



1



You Must Review Your Vehicle Owner's Manual

Your vehicle owner's manual will let you know which vehicle belts and seating positions car seats can be installed in.

2



Check How This Car Seat Will Be Locked Into Place

The vehicle belt **must not** loosen after tightening. This means

there needs to be a way to lock the vehicle belt.

The ways this can be done are:

- By using the seat belt's retractor, see step 3; **OR**
- By using the seat belt's latch plate, see step 4.

continued on next page



3

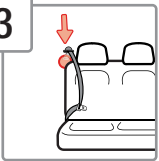

Check Retractor

Retractors pull seat belts into stored positions and lock the belt to hold passengers in place.

See the following heading, “Types of Retractors”, for some common types of vehicle belt retractors that will work with this car seat.

Types of Retractors

Switchable Retractor
(most vehicles have this type)



This retractor can be switched to a locking mode.

You **must have the retractor in the locking mode** to use the seat belt with this car seat.

Switching to locking mode: Slowly pull the shoulder belt all the way out, then let it go back in **1-2 in.** (2.5-5 cm).

As it goes back in, you will most likely hear a ratcheting sound.

Gently pull the belt to see if it has locked. You will not be able to pull any more belt out if the lock has engaged.



Automatic Locking Retractor



This retractor always locks.

It will automatically lock after slowly pulling the seat belt out at least halfway and letting the belt go back into the retractor **1-2 in.** (2.5-5 cm).

Emergency Locking Retractor

See Step 4, “Check Latch Plates”.

If the retractor does not lock, it is most likely an Emergency Locking Retractor. These retractors only lock during a sudden stop or collision.

You will need to determine if your seat belt’s latch plate can lock the belt. See step 4, “Check Latch Plates”.

4



Check Latch Plates

Latch plates are the part of the seat belt that goes into the buckle.

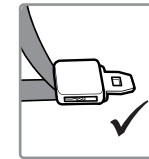

Locking Latch Plate

To see if the latch plate locks:

1. Buckle Vehicle Belt
2. Firmly Tug Lap Portion of Seat Belt While Pulling It Up

continued on next page



If the vehicle belt does not slide through the latch plate, it's locked.

If the latch plate slides up and down the vehicle belt, it is a **sliding latch plate**.

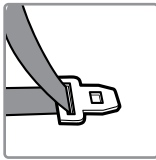

Emergency Locking Retractor with a Sliding Latch Plate

Sliding latch plates easily slip between the lap and shoulder portions of the belt.

If you have an Emergency Locking Retractor with a Sliding Latch Plate, you must use a locking clip.

Please contact us for one, see page 60.

Never Use With This Car Seat	
Emergency Locking Retractor Lap Only Belt	✗
Inflatable Seat Belts	✗



For Forward-Facing Mode Only

Your vehicle's features may be considerably different than those pictured here.

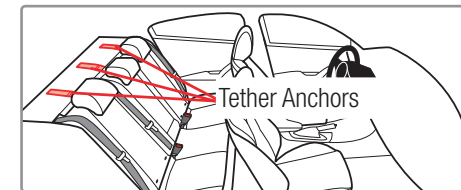

You **must always attach, adjust, and secure the tether (top anchorage) strap** when installing the car seat in the **Forward-Facing Mode** with internal harness. Tethers improve the installation and stability of car seats and reduce the risk of injury. Attach the tether hook to the tether anchor designated by your vehicle manufacturer for that seating position. Check your vehicle owner's manual for more information. If the seating position does not have a tether anchor, use a different seating position or see your dealer or a qualified mechanic and have one installed.

⚠ Using this child restraint without the tether strap anchored as required by the manufacturer would be a misuse of the child restraint and, in a sudden stop or crash, could result in serious injury or death.

Do not fasten multiple tether hooks on the same tether anchor in the vehicle.

continued on next page

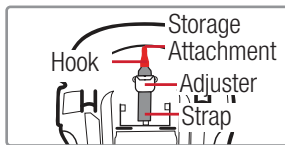

Tether Storage and Parts

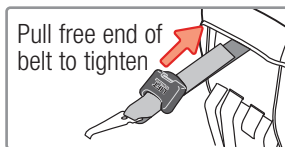

Pull free end of belt to tighten

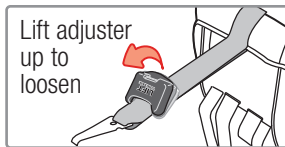

Lift adjuster up to loosen

Storing Tether Strap

When the car seat is not installed in a vehicle, attach the tether hook to its storage attachment on the back of the car seat as shown.

Gently tighten to remove slack.

Adjusting Tether Strap

To tighten: After the car seat is locked into place with the lower anchor belt or vehicle belt, push down on the car seat and gently pull on the free end of the tether strap.

To loosen: Lift up on the tether adjuster and push it towards the tether hook.



**30-65 lb (13.6-29 kg) and 32-49 in. (81.3-125 cm)
and at least 1 year old**

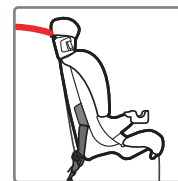

Lower Anchor Belt with Tether

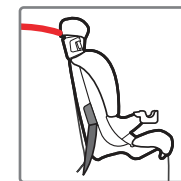

Lap Belt with Tether



Lap/Shoulder Belt with Tether



continued on next page



Do not use the lower anchor belt along with the vehicle lap or lap/shoulder belt.

Check the vehicle belt or the lower anchor belt before each use. Use only if the belt can be tightened properly and locked securely in place.

Do not fasten multiple lower anchor hooks on the same lower anchor bar in the vehicle.

Even when unoccupied, this child restraint must be firmly secured to the vehicle with a lower anchor belt or with the vehicle seat belt.

In this child restraint your child must be at least 1 year old and weigh 22 lb (10 kg) before they sit forward-facing.



Before you begin installing the seat into your vehicle, did you check:

Your child's weight and height?

See page 20.

Your child's fit? See page 7.

Do you need to make adjustments to the harness strap position?



1 Place Car Seat Forward-Facing in Back Seat

2



(top anchorage)

Loosely Attach Tether Hook

Check your vehicle owner's manual for specific tether anchor locations.

3



Check if Your Vehicle Belts Will Work With This Car Seat

This is very important because **not all vehicle belts will work with car seats.** Review pages 13-17 and your vehicle owner's manual to find out what kind of vehicle belt you have and how to lock a car seat in place.

continued on next page

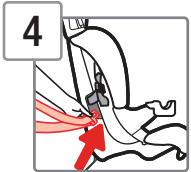

4 **Locate Forward-Facing Belt Path**
Thread the vehicle belt through **Forward-Facing Belt Path** opening as shown.

The belt goes:

- across the car seat; **AND**
- under the car seat pad; **AND**
- out the other **Forward-Facing Belt Path** opening. **Do not twist belt.**

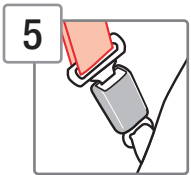

5 **Buckle Vehicle Belt**



6 **Tighten Tether**
Push firmly on the back of the car seat and pull the free end of the tether strap to remove all of the slack.



7 **Tighten Belt**
Place your hand in the car seat. Firmly push the car seat down and back towards the vehicle seat back while pulling the shoulder belt or the free end of lap belt parallel with the **Forward-Facing Belt Path**.

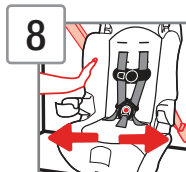

8 **Check Belt Tightness**
Hold the car seat at the **Forward-Facing Belt Path** with your weaker hand. Push and pull the car seat from side to side. It should not move more than **1 in.** (2.5 cm).

If it moves more than 1 in. (2.5 cm), you can try:

- Putting your knee in the car seat and pulling the belt tighter; **OR**
- Reinstalling the car seat; **OR**
- Changing to a different seating location; **OR**
- Switching to lower anchor belt installation if lower anchor are available in your vehicle

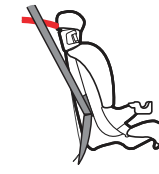

Finished!

Check the tightness of the install often to make sure it has not loosened.



Securing Child in Car Seat

To properly secure your child in the car seat, see pages 29-32.

Check your child's fit often and make any needed adjustments to the car seat as they grow.



Before you begin installing the seat into your vehicle, did you check:

Your child's weight and height?

See page 20.

Your child's fit? See page 7.

Do you need to make adjustments to the harness strap position?



1 Remove Lower Anchor Belt from Storage Location

Or pull lower anchor belt packaging out of Forward-Facing belt path. Remove lower anchor from packaging. Discard the packaging.

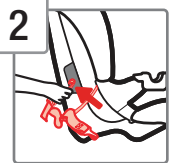

2 Locate Forward-Facing Belt Path

Thread the hook through the Forward-Facing Belt Path opening

as shown.

The adjuster can be on either side of the car seat.

The belt goes:

- across the car seat; **AND**
- under the car seat pad; **AND**
- out the other **Forward-Facing Belt Path** opening.

Do not twist belt.

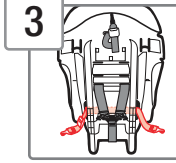

3 Finished Lower Anchor Belt Routing



4 Place Car Seat Forward-Facing in Back Seat

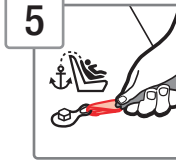

5 Loosely Attach Tether Hook

Check your vehicle owner's manual for specific tether (top anchorage) anchor locations.

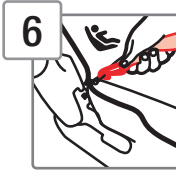

6 Attach Lower Anchor Hooks to Vehicle's Lower Anchor

Review your vehicle owner's manual for lower anchor locations and lower anchor belt use. Fasten one hook to one vehicle lower anchor bar. Then repeat for the second hook on the other side of the car seat.

continued on next page



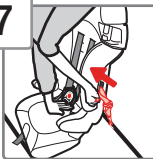

7

**Tighten Belt**

Place your hand in the car seat.

Firmly push the car seat down and back towards the

vehicle seat back while pulling the free end of the belt parallel with the **Forward-Facing Belt Path**.

8

**Tighten Tether**

Push firmly on the back of the car seat and pull the free end of the tether strap to remove all of the slack.

9

**Check Belt Tightness**

Hold the car seat at the **Forward-Facing Belt Path** with your weaker hand.

Push and pull the car seat from side to side. It should not move more than **1 in. (2.5 cm)**.

If it moves more than 1 in. (2.5 cm), you can try:

- Putting your knee in the car seat and pulling the belt tighter; **OR**
- Reinstalling the car seat; **OR**
- Changing to a different seating location; **OR**
- Switching to vehicle belt installation

**Finished!**

Check the tightness of the install often to make sure it has not loosened.

**Securing Child in Car Seat**

To properly secure your child in the car seat, see pages 29-32. Check your child's fit often and make any needed adjustments to the car seat as they grow.

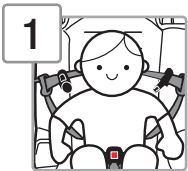

1

Place Child in Car Seat

Your child's bottom and back should be flat against the car seat.

Position the harness straps over your child's shoulders and upper thighs.



2

Buckle Harness

Push the buckle tongues into the buckle until you hear them "click".

Pull up on the harness straps to make sure the buckle is locked.

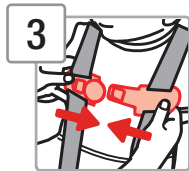

3

Fasten Chest Clip

Insert right half of the chest clip into the left half and snap together.

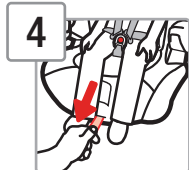

4

Tighten Harness

Pull the harness adjustment strap straight out to snugly tighten the harness system.

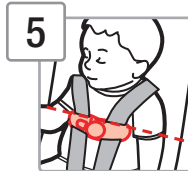

5

Position Chest Clip

Slide the chest clip up the harness straps and position it at mid-chest (even with armpits) and away from your child's neck.



6

Check Harness Tightness

Try to pinch the harness strap at the shoulder vertically between your index finger and thumb as shown.

If your fingers slip off, the harness system is tight enough. **If you can pinch the harness strap**, tighten more.

A snug strap should not allow any slack. It lies in a relatively straight line without sagging. It does not press on the child's flesh or push the child's body into an unnatural position.



Finished!

Your child is now secured in the car seat.
Check your child's fit often and make any needed adjustments to the car seat as they grow.

To Remove Child from Car Seat:

1. Loosen Harness Strap
2. Unbuckle Harness
3. Release Chest Clip
4. Remove Child

⚠ Failure to fasten and tighten the harness system correctly may allow the child to be ejected from the child restraint in a crash or sudden stop causing serious injury or death.

Do not mistake comfort for safety. Harness system must be snugly adjusted.



DO NOT put snowsuits or bulky garments on your child when placing them in the child restraint.

Bulky clothing can prevent the harness straps from being tightened properly.



Booster Seat Mode

40-120 lb (18.1-54.4 kg) and 43-57 in. (110.1-144.8 cm)



Lap/Shoulder Belt

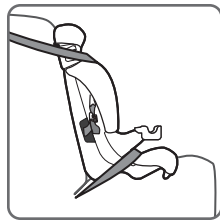

Keep the booster seat securely belted even when unoccupied.



Use only the vehicle's lap and shoulder belt system when restraining the child in this booster seat.

Do not use only the lap belt when using this seat as a booster seat. The shoulder belt must always be adjusted snugly across the child's chest. Never place shoulder belt under the child's arms or behind their back.

Do not use this booster seat if the tops of your child's ears are above the top of the booster seat's headrest.

Do not use the LATCH system when using as a booster seat. Secure the lower anchor belt and the tether strap to their storage attachments.

Removing Harness System

Only remove the harness system to clean the seat pad or to convert to Booster Seat Mode.

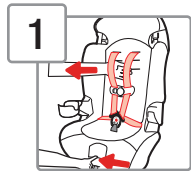

1 Fully Loosen
Harness Straps

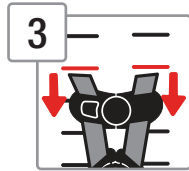

3 Pull Harness
Strap Out
of Shoulder
Harness Slots

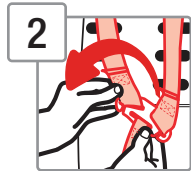

2 From Back of
Seat, Remove
Harness Strap
Loops From
Splitter Plate

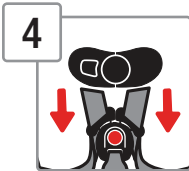

4 Unthread
Chest Clip

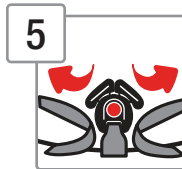

5 Unthread Buckle
Do not unbuckle.

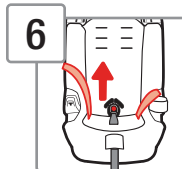

6 Pull Harness Strap
Out of Car Seat

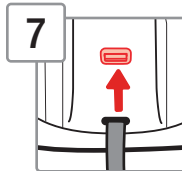

7 Turn Car Seat Over
Locate the buckle's
metal retainer on the
bottom of the shell.



8 Rotate Metal
Retainer and
Push It Up
Through Shell
and Pad



9 From Top of Car
Seat, Pull Buckle
Out of Shell

Storing Harness System

To store the harness system for Booster Seat Mode, you must remove the harness system. See pages 35-36.

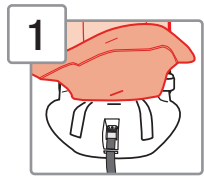

1 Lift up Front Bottom of Pad As Shown

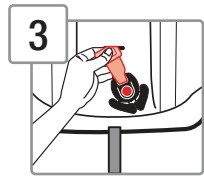

3 Insert Buckle's Metal Retainer Up Through Buckle Slot As Shown

Buckle will hang down underneath shell when stored.

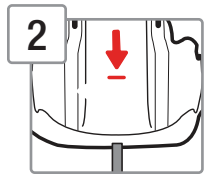

2 Turn Seat Over and Locate Buckle Slot on Bottom of Shell

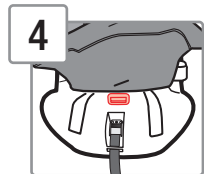

4 From Top of Seat, Lay Metal Retainer Flat Against Shell As Shown

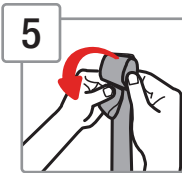

5 Wrap Harness Strap Around Itself As Shown

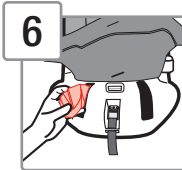

6 Place Wrapped Harness Strap into Slot for Storage

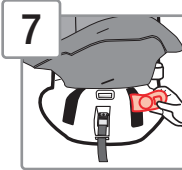

7 Place Chest Clip into Slot for Storage

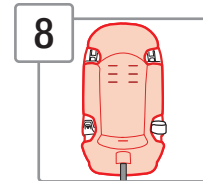

8 Replace Pad

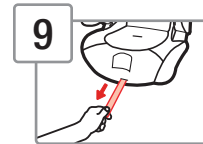

9 Secure Splitter Plate

Pull the harness adjustment strap toward you so the splitter plate is flush against the shell, as shown.

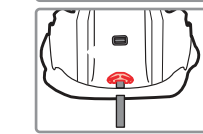



Booster Seat Child Fit



Head Position

Tops of the child's ears should never be above the top of the booster seat's headrest.

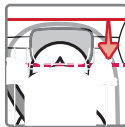

Tops of child's ears below the top of your vehicle's seat back or vehicle's headrest.



Shoulder Belt Position

The shoulder belt should lay across your child's chest, centered on the edge of their shoulder, and away from their face and neck.



Lap Belt Position

The lap belt should lay snugly across the child's hips and not on their stomach.



Lap/Shoulder Belt Use



1

Place Booster Seat Forward-Facing Flush Against Vehicle Seat Back

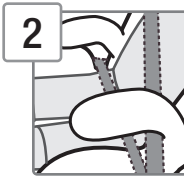

2

Position Lap Belt on Child

The lap belt should lay snugly across the child's upper thighs and not on the stomach.

The lap belt **must** go under both armrests. The shoulder belt **must** only go under the armrest on the buckle side as shown.

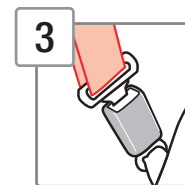

3

Buckle Vehicle Belt

continued on next page



4



Position Shoulder Belt on Child

Pull up on shoulder belt to tighten.

The shoulder belt should lay across

your child's chest, centered on the edge of their shoulder away from their face and neck, and around the side of the car seat.

Check periodically to ensure your child has not moved out of position and loosened the shoulder belt.



NOTE: DO NOT thread the shoulder belt through the slots in the side of the car seat if they are present on your model.

Removing Seat Pad for Cleaning

You must remove the harness system to remove the pad from the shell. See pages 35-36.

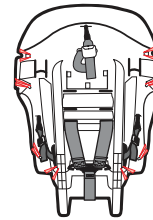

Release Elastic Straps From Tabs on Back of Shell

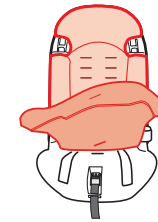

Remove Pad

Pull the pad off the bottom of the car seat and remove the pad.

continued on next page

Cleaning Parts of Car Seat and Installing Seat Pad Set

Cleaning Pad and Accessories

Machine wash separately with cold water on a gentle cycle. Do not use bleach. Tumble dry separately for 10-12 minutes on low heat. Remove immediately.

Cleaning Harness Strap

Check the harness straps often for any wear or damage.

Spot clean using warm sudsy water and damp cloth.

Spilled food and liquids on the car seat may result in mold or bacterial growth over time. These spills could also attract insects or rodents.

Cleaning Buckle & Car Seat Shell

Spot clean using warm sudsy water and damp cloth. Do not submerge into water.

Replace Pad

Starting from bottom of car seat, slip pad on shell. Pull harness adjustment strap through pad. Wrap pad around the top of shell. Attach all of the elastic straps. Install harness system, see pages 44-47.

⚠ Do not use the child restraint without the seat pad or with damaged harness straps.

Installing Harness System

1

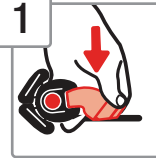

Insert Buckle's Metal Retainer into Slot

The buckle **must** face out.

3



Check Buckle

Pull up on the buckle to make sure it is secured.

The buckle **must** not pull out.

2



Pull Metal Retainer Completely Through Pad and Shell

4

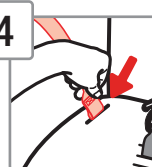

Rethread Harness Strap

With the sewn end of the harness strap loop facing the buckle, thread

the harness strap down through the hip harness slot.

continued on next page

5

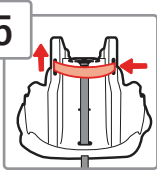

Pull Harness Strap Across Bottom of Shell

The harness strap **must** lie in front of the harness adjustment strap as shown. Push the harness strap up through other the hip harness slot.

6

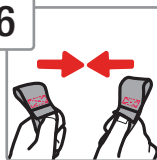

Make Harness Strap Even

The sewn ends of harness strap loops **must** face each other.

7



Thread Buckle and Chest Clip

The harness strap ends go through the **back** of the buckle tongues and through the chest clip **front to back** as shown.

8

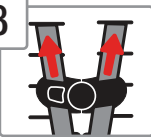

Thread Harness Straps Into Correct Shoulder Harness Slots For Your Child

For Forward-Facing child fit, see page 7.

9



Attach Harness Strap Loops to Splitter Plate As Shown

The sewn ends of the harness strap loops **must** face towards you.

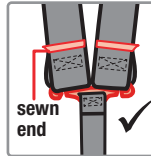

Do not twist the harness strap or the harness adjustment strap.

Make sure the harness strap loops are fitted **completely on** both sides of the splitter plate.

Check your child's fit often.

To learn how to check harness tightness, see pages 29-32.

Check the harness straps often for any wear or damage.

continued on next page

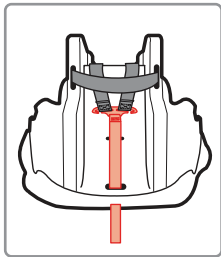

⚠ Failure to place harness adjustment strap behind the harness strap as shown can result in serious injury or death.

Do not use a child restraint with damaged harness straps.

This restraint is certified for aircraft use when used with the internal harness.

This restraint is not certified for aircraft use when used as a booster seat because aircraft seats do not have shoulder belts.

Install the child restraint in a window seat to avoid blocking the aisle. If the aircraft lap belt is too short, ask the flight attendant for a belt extender.

Use only on forward facing aircraft seats. Contact the airline for their specific policies.

Some airlines may ask to see a label stating that this child restraint is certified for aircraft use.

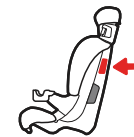

There is an airplane certification label located on the side of this child restraint as shown.

⚠ Store the lower anchor belt and tether strap when installing with aircraft belts.



Forward Facing Aircraft Installation

Follow the steps on pages 22-24, skipping the tether strap steps.

Do not risk your child's safety.

To keep your child as safe as possible, Dorel Juvenile Group strongly recommends replacing the car seat even after a minor crash; even if it was not occupied at the time.

Replacement After a Minor Crash

The National Highway Traffic Safety Administration states that for a crash to be considered minor **ALL of the following must be true:**

- Vehicle able to drive away from the crash site; **AND**
- Vehicle door nearest the car seat was not damaged; **AND**
- No passengers were injured; **AND**
- Airbags did not deploy; **AND**
- There is no visible damage to the car seat.

If the crash your car seat was involved in meets **ALL** the criteria, you may not need to replace the car seat.

If one or more of these criteria are not true or if you are uncertain of any of your answers, replace the car seat immediately.

Replacement After a Moderate to Severe Crash

You **must** replace this car seat if it has been in a moderate to severe car crash. This car seat is intended to protect a child in a single crash. During a crash, the car seat and all of its parts absorb crash energy which can deform or weaken it. Damage is not always visible. A damaged car seat must be replaced immediately.

**Expiration**

On the side of the child restraint there is a date of manufacture label as shown. Do not use this child restraint more than 10 years after the date of manufacture.



Child Restraint Use

Never take your child out of the child restraint while the vehicle is moving.

Never leave child unattended.

Placing your child in a hot child restraint may result in burns.

Do not use a child restraint with damaged or missing parts.

Do not use a child restraint with cut, frayed or damaged harnesses.

Do not substitute parts or try to modify the child restraint in any way.

Do not lubricate buckles and fasteners.

Do not use any child restraint accessory except those approved by Dorel Juvenile Group.

Never allow any child to play with this child restraint; it is not a toy.

Do not remove or cover up any of the warning labels or other labels on the child restraint.

This child restraint has been certified for use in passenger vehicles. Do not use in a boat, on a motorcycle or in a cargo van or bus where there are no seat belts or tether anchors.

Read all instructions for additional warnings.



Installation in Vehicle

Check the vehicle belt or UAS belt before each use. Use only if the belt is tightened properly and locked securely in place.

Even when unoccupied, this child restraint must be firmly secured to the vehicle with a lower anchor belt or with the vehicle seat belt.

Even when unoccupied, this booster seat must be firmly secured to the vehicle with the vehicle seat belt.

In a crash or sudden stop, an unsecured child restraint or booster seat could injure occupants.

Vehicle Seating Position



Never place a child rear-facing in a seating position with an active frontal air bag.

Check the vehicle owner's manual for more information about air bag/child restraint use.



Use the child restraint only on vehicle seats that face forward.



Do not use on seats that face the sides or rear of the vehicle.



For vehicles without a back seat, refer to your vehicle owner's manual.

Children are safer when properly restrained in rear seating positions than in the front seating positions.

According to accident statistics, children in rear seating positions are statistically safer, whether you have air bags, advanced air bags, or no air bags at all.

If you are not sure where to place the child restraint in your vehicle: consult your vehicle owner's manual; contact Dorel Juvenile Group Consumer Care Department; or visit your local Child Passenger Inspection Station. Go

to <https://www.nhtsa.gov/equipment/car-seats-and-boosters> to find your closest station.

To avoid your child being seriously burned, take the following precautions:

1. Park in the shade or where sun does not directly hit the child restraint.
2. Cover the child restraint with a sheet or blanket when not in use.
3. Check for hot seat and buckles before placing child in child restraint.

To help protect your vehicle seat's upholstery from damage, you may use an accessory approved by Dorel Juvenile Group or a single layer towel underneath and behind car seat.

Please complete the postage-paid registration card that came with your child restraint, and send it to us. Child restraints could be recalled for safety reasons. You must register this restraint to be reached in a recall. Send your name, address, e-mail address if available and the restraint's model number and manufacturing date to:

Dorel Juvenile Group
2525 State Street
Columbus, IN 47201

or call 1-800-544-1108 or register online at <https://www.safety1st.com/registration>.

For recall information, call the U.S. Government's Vehicle Safety Hotline at 1-888-327-4236 (TTY: 1-800-424-9153), or go to www.NHTSA.gov.

continued on next page

0515079 Tear Off and Mail This Part or Register Online 4348-00810

Consumer: Just fill in your name, address and email. Please print (use dark ink).

Your Name _____

Model Number _____ Line Code _____ Manufacture Date _____

Model Number: BC098-BVM Model Name: COSCO TRIPLE L-1 Manufacture Date: 01/22/2015

L#11 B265035

Example of model number, line code and manufacture date.



If you don't have the card or if your address changes, you will find the model number, manufacture date, and line code on the label located on side of shell.

1. If the child restraint buckle or harness release lever sticks or you cannot get the straps tight enough around child:

DO NOT LUBRICATE. Check around lever and retractor for dropped food, sticky spilled drinks, dirt, leaves, etc. Clean with warm water and/or remove object with tweezers. If you cannot get the harness to adjust and remain tight with the buckle securely locked, do not use the child restraint.

2. If your harness twists:

Straighten the harness each time you put your child in the child restraint to help prevent twisting. Lock the buckle and tighten harness and it will be ready for next use.

Dorel Juvenile Group, Inc. (DJG) warrants this product to the original retail purchaser as follows:

This product is warranted against defective materials or workmanship for one year from the date of original purchase. **An original receipt is required to validate your warranty.** DJG will, at its option, provide replacement parts or replace this product. DJG reserves the right to substitute if the part or model has been discontinued.

To make a claim under this warranty, please contact our Consumer Care Department by phone: 1-800-544-1108; text: 1-812-652-2525; or chat with us: www.safety1st.com. Our hours of operation are from 8:00 a.m. to 6:00 p.m. EST Monday through Thursday and from 8:00 a.m. to 4:30 p.m. on Friday.

Proof of purchase is required and shipping charges are the responsibility of the consumer.

Warranty Limitations: This warranty does not include damages which arise from misuse or abuse of this product.

Limitation of Damages: The warranty and remedies as set forth are exclusive and in lieu of all others, oral or written, expressed or implied. In no event will DJG or the dealer selling this product be liable to you for any damages, including incidental or consequential damages, arising out of the use or inability to use this product.

This warranty gives you specific legal rights, and you may have other rights, which vary from state to state. Neither DJG nor the dealer selling this product authorized any person to create for it any other warranty, obligation, or liability in connection with this product.

Limitation of warranties and other warranty terms and state law rights: Any implied warranties, including implied warranties of the merchantability and fitness for a particular purpose, shall be limited to the duration and terms of the express written warranty.

Some states do not allow limitations as to how long an implied warranty lasts or the exclusion or limitation of incidental or consequential damages, so the above limitations may not apply to you. This warranty gives you specific legal rights, and you may have other rights, which vary from state to state. Neither DJG nor the dealer selling this product authorized any person to create for it any other warranty, obligation, or liability in connection with this product.

Chest Clip
 Buckle Assembly
 Seat Pad Set
 Tether
 Lower Anchor Belt
 Harness Strap
 Instructions
 Locking Clip

**If requested color is not available,
 similar color will be substituted.**

**Applicable tax and shipping &
 handling will also be added.**

For parts availability and questions,

Call: 1-800-544-1108

Text: 1-812-652-2525

Chat: www.safety1st.com

**If you already know which parts you
 need,** you may complete your order with
 a credit card by calling us at 1-800-544-
 1108.

We accept Visa or MasterCard.

Hours of Operation:

M-TH: 8:00 AM - 6:00 PM EST
 FRI: 8:00 AM - 4:30 PM EST

Thank you for choosing this child restraint. The DJG family is committed to creating child restraints with the most comfort and convenience available today.

Remember, parents are a child's first teachers and examples. If you always buckle your seat belt, your child will think it is the natural thing to do. Make it a firm rule that the vehicle does not go until everyone is buckled up. Make no exceptions.

No one can predict if use of a child restraint will prevent injury or death in a particular crash. However, when combined with careful driving, proper use of a child restraint can lower a child's risk of injury or death in most crashes.

Your child's safety is worth the time it will take to read and follow these instructions. After reading, if you still have questions or have any concerns with this child restraint, please contact our Consumer Care Department:

Call: 1-800-544-1108

Text: 1-812-652-2525

Chat: www.safety1st.com

Hours of Operation:

M-TH from 8:00 AM to 6:00 PM EST

FRI from 8:00 AM to 4:30 PM EST