



www.safety1st.com

onBoard 35 LT Infant Car Seat



KEEP INSTRUCTIONS FOR FUTURE USE.
Read all instructions before
using this car seat.

WARNING  Failure to follow the
warnings on the labels and in the
instruction manual can result in
serious injury or death
to your child.



4358-8077

8.26.20

Overview

Welcome to the Safety 1st family and thank you for choosing this car seat, also known as a child restraint!

To help you get started using your child's new car seat, here are the 4 main tasks you'll need to complete:

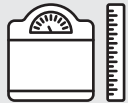

Measure Your Child



Adjust Car Seat to Fit Your Child



Install Car Seat into Your Vehicle



Snugly Secure Your Child in Car Seat

Your child's safety is worth the time it will take for you to read and follow these instructions.

Ready? Let's go!

Pages 1-3 will introduce you to the parts of the car seat.

Page 58 has our contact information. If at any point you would like assistance, please feel free to reach out to us.

Quick Navigation



REAR-FACING

**4-35 lb (1.8-15.9 kg) and
32 in. (81.3 cm) or less in height**

PAGE 4



Rear-Facing Child Fit **PAGE 6**



Adjusting Car Seat **PAGES 7-18**



Securing Child **PAGES 19-21**



Install
with
Base



Install
without
Base



Vehicle Belt
PAGE 29



Lower
Anchor Belt
PAGE 33



Vehicle Belt
PAGE 38

Contents

Getting Started

Parts of Car Seat	1
Accessory Use	3
Rear-Facing Use Requirements	4
Preparing Car Seat for Child Fit	5
Rear-Facing Child Fit	6

Making Adjustments to Car Seat

Changing Harness Strap Position	7
Changing Buckle Position	9
Harness System Adjustments for Smaller Infants	11
Removing and Installing Car Seat to Base	14
Base Use	15
Canopy Use	16
Carrier Use	18

Securing Child in Car Seat 19

Choosing LATCH or Vehicle Belt

LATCH: Lower Anchor Use	22
Vehicle Belts	24

Installation in Vehicle

Rear-Facing Use with Base	28
Vehicle Belt Install	29
LATCH: Lower Anchor Belt Install	33
Rear-Facing Use Without Base	37
Vehicle Belt Install	38

Wash & Care of Car Seat Parts

Removing Harness System	41
Removing Seat Pad Set for Cleaning	44
Cleaning Parts of Car Seat and Installing Seat Pad Set	46
Installing Harness System	47

Safety Information

Aircraft Information	50
Replacement and Expiration of Car Seat	51
Child Restraint Use	52
Installation in Vehicle	52
Vehicle Seating Position	53
Registration and Safety Notices	54

Additional Information

Warranty	55
Troubleshooting	56
Replacement Parts List	57
Dorel Juvenile Group Information	58

Parts of Car Seat

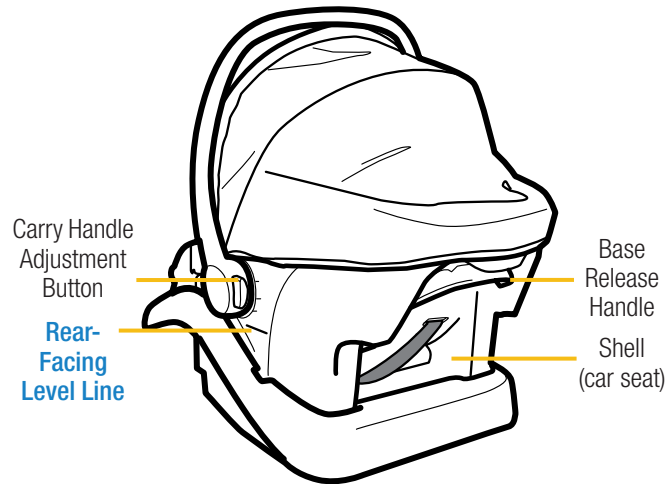
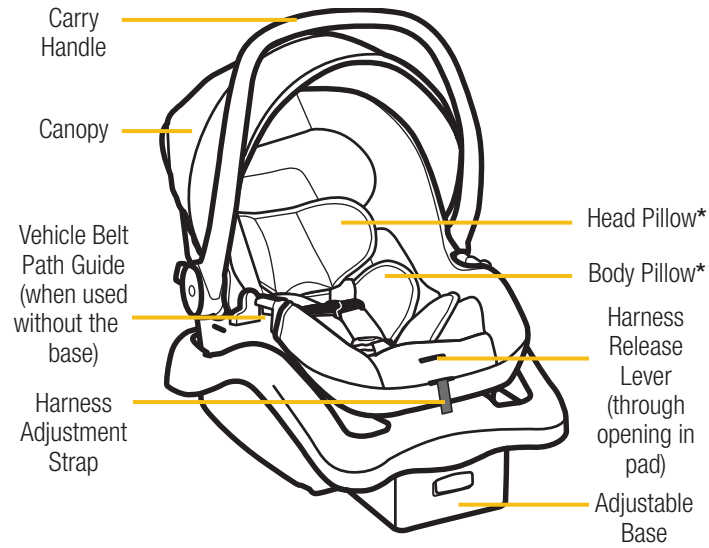

*See page 3 for Accessory Use.

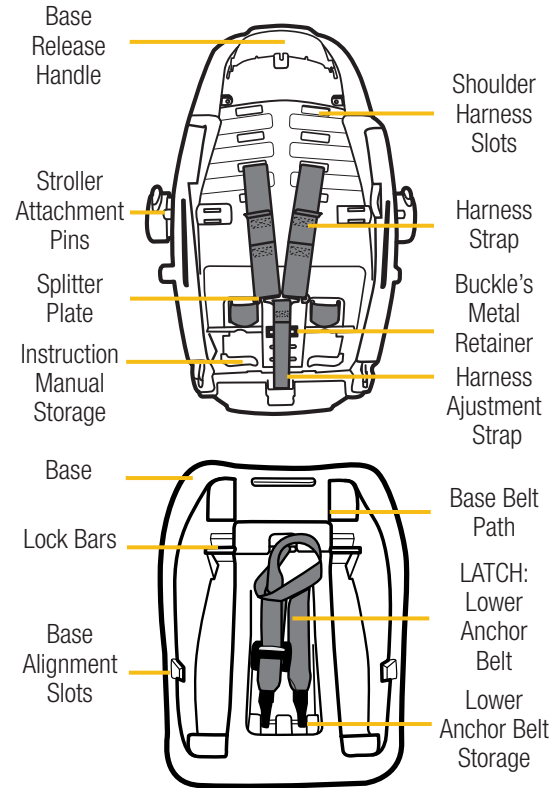

Harness System Detail

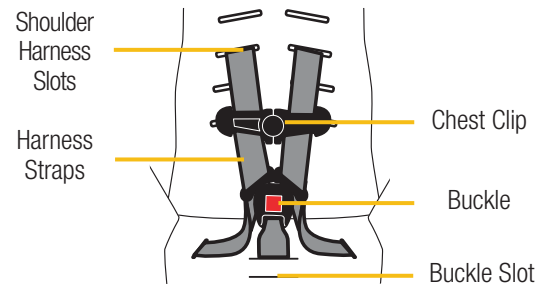



Head Pillow

When using the head pillow, make sure it does not cover your infant's face in any way.

To remove, pull the head pillow up from behind the body pillow.

You **must use** the body pillow in order to use the head pillow.

Reverse the order to install the head pillow.



Body Pillow

To remove, unbuckle the harness. Pull the buckle down through the slot in the body pillow.

Slide it out from behind the harness straps.

Reverse the order to install the body pillow.

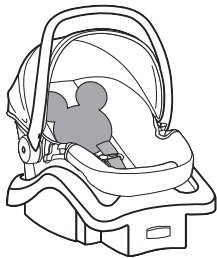

Head Pillow

When using the head pillow, make sure it does not cover your infant's face in any way.

To remove, from the back of the car seat, remove the harness straps from the splitter plate. Pull the harness straps through the shoulder harness slots and head pillow. Remove the head pillow.

Thread the harness straps through the shoulder harness slots.

Reattach harness strap loops to the splitter plate. See pages 7-8.

Reverse the order to install the head pillow.

⚠ Measure your child's weight and height (do not guess) before choosing the car seat's mode.

Your child's height, weight, and age determine how the car seat should be placed in the vehicle. Children vary widely in body size, shape, and temperament—**please consult your doctor before switching between any types or modes of car seats within the limits and fit requirements of the seat.**

State Laws

Please be certain to follow your state's laws regarding car seat use.

American Academy of Pediatrics Recommendations

Infants and Toddlers: Should ride in a rear-facing car seat as long as possible, until they reach the highest weight or height allowed by their seat.

Toddlers and Preschoolers: Once they are facing forward, children should use a forward-facing car seat with a harness for as long as possible, until they reach the height and weight limits for their seats.

School-Aged Children: Once they have outgrown their forward-facing car seat, children should use a belt-positioning booster seat until the vehicle's lap and shoulder seat belt fits properly. This is often when they have reached at least 4 feet 9 inches in height and are 8 to 12 years old.

Older Children: All children younger than 13 years should be restrained in the rear seats of vehicles for optimal protection.

REAR-FACING



4-35 lb (1.8-15.9 kg) and 32 in. (81.3 cm) or less in height

Children under 1 year of age must ride **Rear-Facing**.

This car seat can only be used Rear-Facing.

Your child can remain in this car seat until they outgrow any one of the following:

- **Weight Limit:** 35 lb (15.9 kg); **OR**
- **Height Limit:** 32 in. (81.3 cm); **OR**
- **Rear-Facing Child Fit** requirements, see page 6

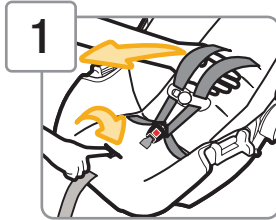

1 Fully Loosen Harness Straps

Push down on the harness release lever (through the opening in the pad) while pulling out on the harness straps as shown.

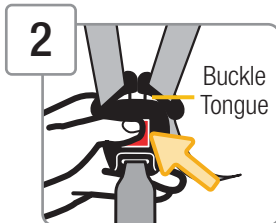

2

2 Unbuckle Harness

Press in on the red button and pull out buckle tongues.

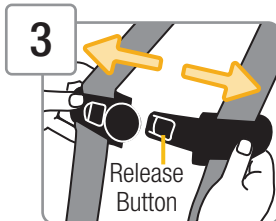

3

3 Release Chest Clip

Hold each side of the chest clip. Press on the release button with your thumb and pull the chest clip apart.

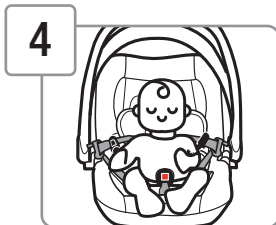

4

4 Place Child in Car Seat to Determine Proper Harness Fit

Your child's bottom and back should be flat against the car seat.

For **Rear-Facing Child Fit**, see page 6.

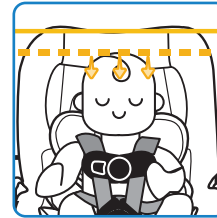

Head Position

The top of your child's head **must be at least 1 in. (2.5 cm) below** the top of the car seat.

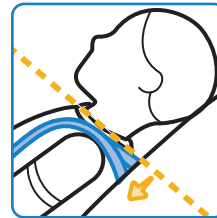

Harness Strap Position

The harness strap **must be at or slightly below** your child's shoulders; **never above**.

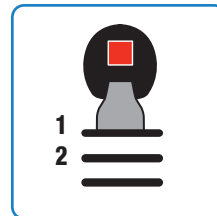

Buckle Position

Choose the slot closest to your child. The buckle **should not be underneath or behind** your child.

Need to make adjustments?

To change harness strap position, see page 7-8.

To change buckle position, see pages 9-10.

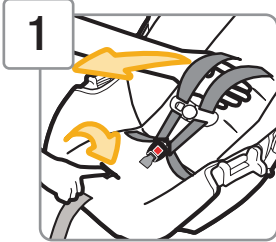

1 Fully Loosen Harness Straps

Push down on the harness release lever (through the opening in the pad) while pulling out on the harness straps as shown.

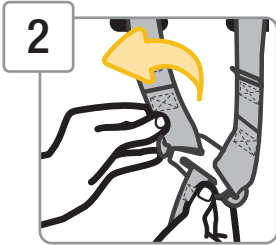

2 From Back of Car Seat, Remove Harness Strap Loops From Splitter Plate

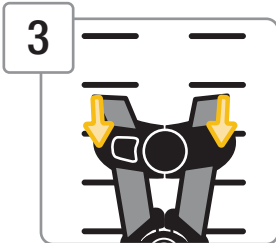

3 Pull Harness Straps Out of Shoulder Harness Slots

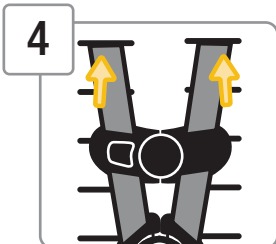

4 Rethread Harness Straps into Correct Shoulder Harness Slots for Your Child

For [Rear-Facing Child Fit](#), see page 6.

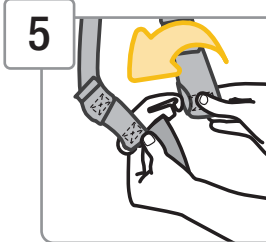

5 From Back of Car Seat, Attach 1st Harness Strap Loops to Splitter Plate As Shown

The sewn ends of the harness strap loops **must** face towards you.

Do not twist the harness strap or the harness adjustment strap.

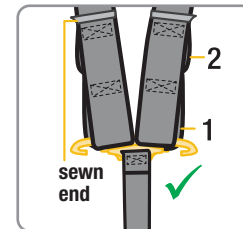

Make sure the harness strap loops are fitted **completely on** both sides of the splitter plate.

Check your child's fit often.

If you cannot achieve a snug harness fit for your child, see pages 11-13.

To learn how to check harness tightness, see pages 19-21.

Check the harness straps often for any wear or damage.

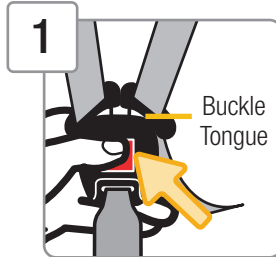
**Unbuckle Harness**

Press in on the red button and pull out buckle tongues.

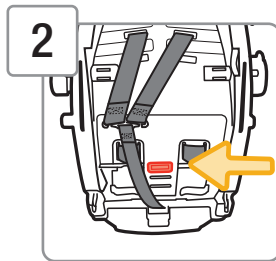
**Turn Car Seat Over**

Locate the buckle's metal retainer on the bottom of the shell.

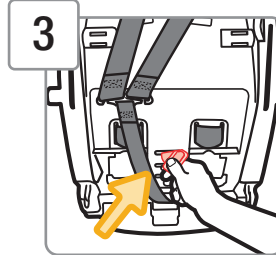
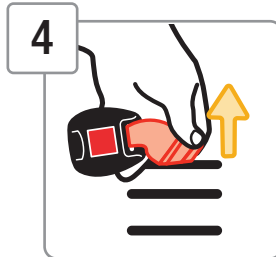
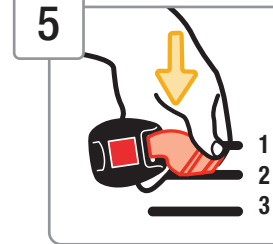
**Rotate Metal Retainer and Push It Up Through Shell and Pad****From Top of Car Seat, Pull Buckle Out of Shell and Pad****Insert Buckle's Metal Retainer into Buckle Slot Closest to Child**

The buckle **must** face out.

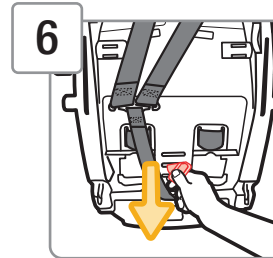
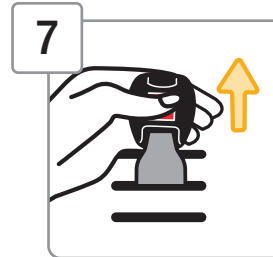
**From Bottom of Car Seat, Pull Metal Retainer Completely Through Pad and Shell****Check Buckle**

Pull up on the buckle to make sure it is secured.

The buckle **must not** pull out.

Check your child's fit often.

If you cannot achieve a snug harness fit for your child, see pages 11-13.

To learn how to check harness tightness, see pages 19-21.

⚠ Failure to place buckle's metal retainer completely through pad and shell can result in serious injury or death.

Harness System Adjustments for Smaller Infants

If you cannot achieve a snug harness fit for your child, you may need to adjust the buckle strap and/or the harness strap length as shown in this section.

Adjusting Buckle Strap Length

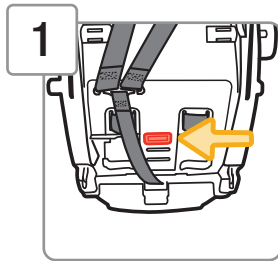

1

**With Buckle in 1st Slot,
Turn Car Seat Over**

If you need to move the buckle to the 1st slot, see pages 9-10.

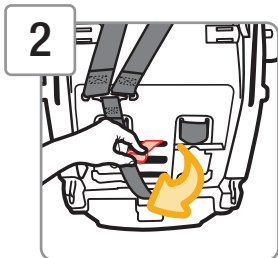

2

**Pull Buckle's Metal Retainer
Towards You, Then Push It up
into Middle Buckle Slot As
Shown**

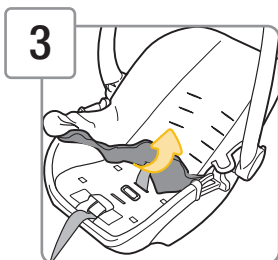

3

Pull Up Front of Car Seat Pad

4

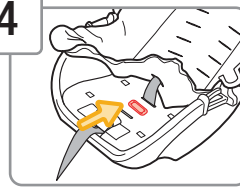

**From Top of Car Seat,
Lay Metal Retainer Flat
Against Shell As Shown**

5

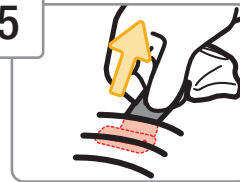

Replace Pad and Check Buckle

Pull up on the buckle to make sure it is secured.

The buckle **must not** pull out.

Adjusting Harness Strap Length

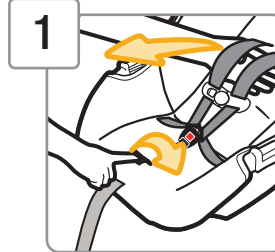

1

Fully Loosen Harness Straps

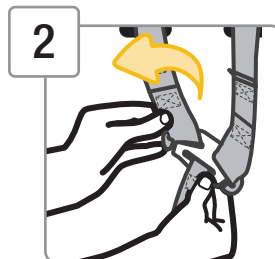

2

**From Back of Car Seat,
Remove Harness Strap
Loops From Splitter Plate**

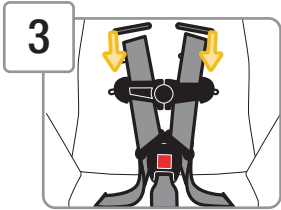

3 Pull Harness Straps Out of Shoulder Harness Slots

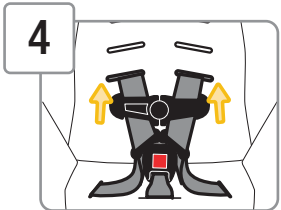

4 Rethread Harness Straps into Correct Shoulder Harness Slots For Your Child

For **Rear-Facing Child Fit**, see page 6.

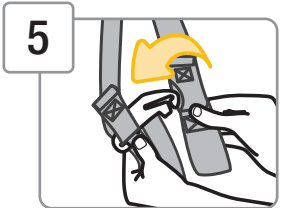

5 Attach 2nd Harness Strap Loops to Splitter Plate As Shown

The sewn ends of the harness strap loops **must** face towards you.

Do not twist the harness strap or the harness adjustment strap.

Make sure the harness strap loops are fitted **completely on** both sides of the splitter plate.

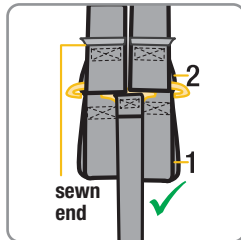

Check your child's fit often.

To learn how to check harness tightness, see pages 19-21.

Check the harness straps often for any wear or damage.

⚠ The harness system must be installed correctly. Do not use a child restraint with damaged harness straps.

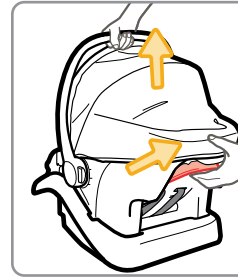

To Remove Car Seat from Base

From the back of the car seat, slide the base release handle up and lift the car seat out of the base.

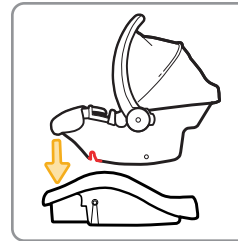

To Attach Car Seat to Base

Align the slots on the side of car seat with the lock bars in the base.

Push down firmly on the carry handle and front of the car seat to lock it to the base. You will hear a "click" when it is locked.

Pull up on the front two corners of the car seat by infant's feet to make sure it is locked to the base.

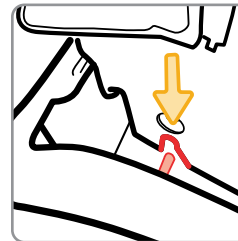

⚠ When installing with a base, only use this car seat with a compatible onBoard 35 LT base.

Failure to use a correct base can cause serious injury or death.

Failure to securely attach child restraint to base can result in serious injury or death.

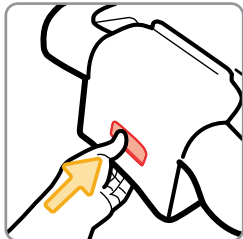

To Lower Base Foot

Push in on the foot release button and pull the foot all the way down.

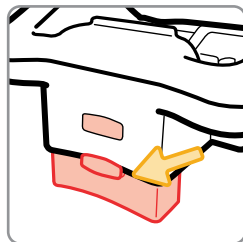
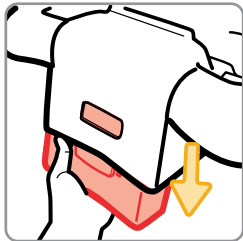

Lock the foot on the release button as shown.

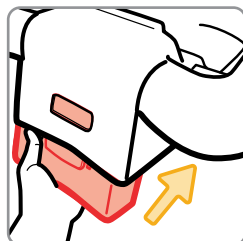

To Store Base Foot

Pull the foot down and press in on the release button.

Push the foot up into the base to the locked position.

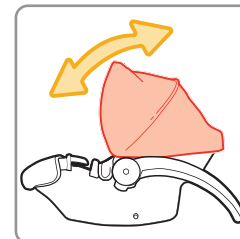
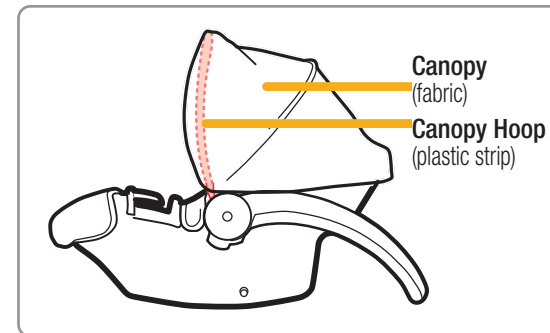

To Adjust Canopy

Grasp the front or sides of the canopy hoop and move it front to back to desired location.

To Clean Canopy

Hand wash using warm sudsy water. Line dry.

To Remove Canopy

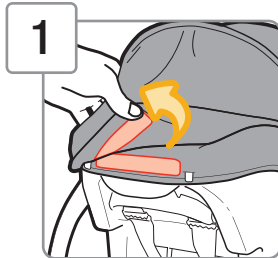

1 Undo Fastening Strip on Back of Shell

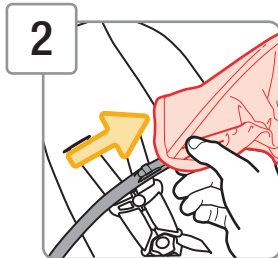

2 Expose Canopy Hoop Connection in Middle of Hoop by Sliding Canopy Fabric to One Side of Shell

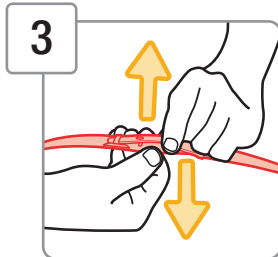

3 Undo Canopy Hoop

Pull the top of the canopy hoop up and the bottom down where they connect.

Then pull the hoop apart and pull the canopy fabric off of the hoop.

Reverse the order to put back together.

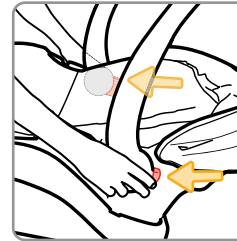
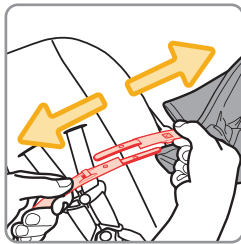

To Adjust Carry Handle

Squeeze both adjustment buttons on each side of the carry handle.

Rotate up or down to desired location. Release buttons.

Make sure both carry handle adjuster buttons are in the locked position.

Carry handle **must** be upright **and** locked when carrying and when installed in the vehicle.

⚠️ WARNINGS

Read ALL instructions before using child restraint as a carrier.

NEVER use carrier unless child is properly secured.

Use only as a carrier by children weighing 4-35 pounds (1.8-15.9 kg) and 32 inches (81.3 cm) or less in height.

NEVER leave child unattended. Always keep child within arm's reach.

Suffocation Hazard: Infant carrier can roll over on soft surfaces and suffocate child. **NEVER** place carrier on beds, sofas or other soft surfaces.

Strangulation Hazard: Children have **STRANGL**ED in loose or partially buckled harness straps. Fully restrain the child even when carrier is used outside the vehicle.



Fall Hazard: Child's movement can slide carrier. **NEVER** place carrier on counter tops, tables, or any other elevated surface.

The carrier can fall from the shopping cart. Do not use on shopping cart.

Do not use the carrier if it is damaged or broken, or if any parts are missing.

1

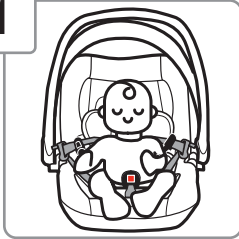
**Place Child in Car Seat**

Your child's bottom and back should be flat against the car seat.

Position the harness straps over your child's shoulders and upper thighs.

2

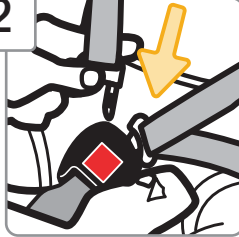
**Buckle Harness**

Push the buckle tongues into the buckle until you hear them "click".

Pull up on the harness straps to make sure the buckle is locked.

3

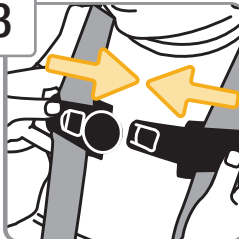
**Fasten Chest Clip**

Insert right half of the chest clip into the left half and snap together.

4

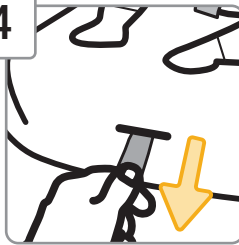
**Tighten Harness**

Pull the harness adjustment strap straight out to snugly tighten the harness system.

5

**Position Chest Clip**

Slide the chest clip up the harness straps and position it at mid-chest (even with armpits) and away from your child's neck.

6

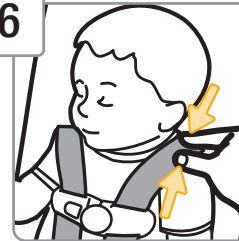
**Check Harness Tightness**

Try to pinch the harness strap at the shoulder vertically between your index finger and thumb as shown.

If your fingers slip off, the harness system is tight enough.

If you can pinch the harness strap, tighten more.

A snug strap should not allow any slack.

It lies in a relatively straight line without sagging.

It does not press on the child's flesh or push the child's body into an unnatural position.

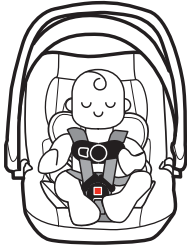

Finished!

Your child is now secured in the car seat.

Check your child's fit often and make any needed adjustments to the car seat as they grow.

To Remove Child from Car Seat:

1. Loosen Harness Strap
2. Unbuckle Harness
3. Release Chest Clip
4. Remove Child



Failure to fasten and tighten the harness system correctly may allow the child to be ejected from the child restraint in a crash or sudden stop causing serious injury or death.



Do not mistake comfort for safety. The harness system must be snugly adjusted.

Do not put snowsuits or bulky garments on your child when placing them in the child restraint. Bulky clothing can prevent the harness straps from being tightened properly.

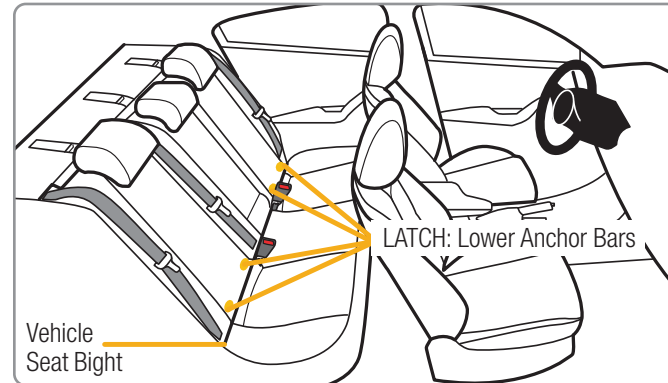

Your vehicle's features may be considerably different than those pictured here.

The lower anchors of **LATCH** (Lower Anchors and Tethers for Children) is a universal system for installing car seats without using vehicle seat belts.

The LATCH: lower anchor belt can **only** be used in vehicles that have the lower anchor bars installed in designated seating positions. Most vehicles manufactured after September 2002 are equipped with LATCH: lower anchor bars.

Check your vehicle owner's manual to see which seating positions may be equipped with LATCH: lower anchor bars.

⚠ Do not use both the lower anchor belt and vehicle belt at the same time. When used correctly the lower anchor belt or the vehicle belts are equally safe.

continued on next page

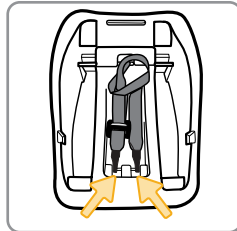

Lower Anchor Belt
Storage Attachments

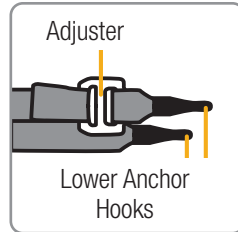

Adjuster
Lower Anchor
Hooks

To Remove Lower Anchor Belt from Storage Attachment on Base

Squeeze the spring lever on the hooks and remove the hooks from the storage attachments.

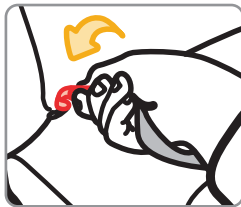

To Remove Lower Anchor Belt from Vehicle's Lower Anchor Bars

Remove the tension from the belt by pushing down on the side of the base with the adjuster. Then press the adjuster's button to loosen the belt.

Remove the hook from the anchor by squeezing the spring lever on the hook, pushing the hook back into the seat bight, and rotating the hook to the side. Then pull the hook out of the vehicle seat bight.

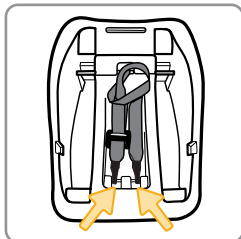

Lower Anchor Belt
Storage Attachments

To Store Lower Anchor Belt

When using the vehicle belts to install or when the base is not installed in a vehicle, the lower anchor belt must be properly stored.

Attach the hooks to the storage attachments in the base.

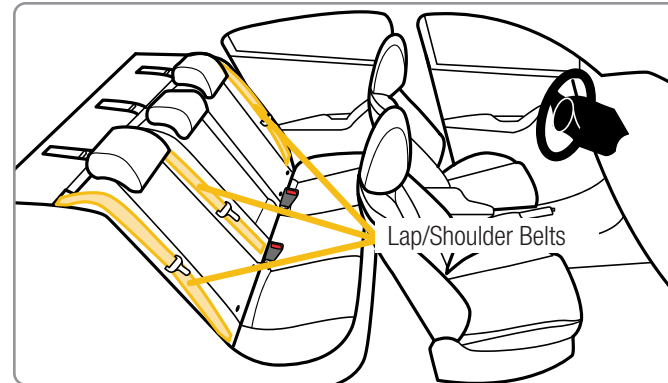

Your vehicle's features may be considerably different than those pictured here.

If LATCH: lower anchors are not an option, you must use the vehicle seat belt system to install the car seat.

Not all vehicle belts and seating positions will work with car seats.

Please go through the following steps to understand how to lock a car seat with a vehicle belt.



1

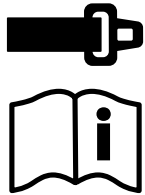

You Must Review Your Vehicle Owner's Manual

Your vehicle owner's manual will let you know which vehicle belts and seating positions car seats can be installed in.

2



Check How This Car Seat Will Be Locked Into Place

The vehicle belt **must not** loosen after tightening. This means there needs to be a way to lock the vehicle belt.

The ways this can be done are:

- By using the seat belt's retractor, see step 3; **OR**
- By using the seat belt's latch plate, see step 4.

3

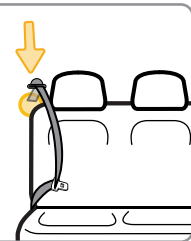

Check Retractor

Retractors pull seat belts into stored positions and lock the belt to hold passengers in place.

See the next page for some common types of vehicle belt retractors that will work with this car seat.



Types of Retractors

Switchable Retractor (most vehicles have this type)



This retractor can be switched to a locking mode.

You **must have the retractor in the locking mode** to use the seat belt with this car seat.

Switching to locking mode: Slowly pull the shoulder belt all the way out, then let it go back in **1-2 in.** (2.5-5 cm).

As it goes back in, you will most likely hear a ratcheting sound.

Gently pull the belt to see if it has locked. You will not be able to pull any more belt out if the lock has engaged.

Automatic Locking Retractor



This retractor always locks.

It will automatically lock after slowly pulling the seat belt out at least halfway and letting the belt go back into the retractor **1-2 in.** (2.5-5 cm).

Emergency Locking Retractor

See Step 4, "Check Latch Plates".

If the retractor does not lock, it is most likely an Emergency Locking Retractor. These retractors only lock during a sudden stop or collision.

You will need to determine if your seat belt's latch plate can lock the belt. See step 4, "Check Latch Plates".

continued on next page

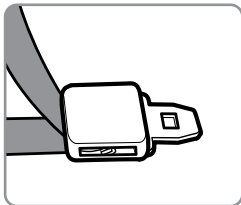
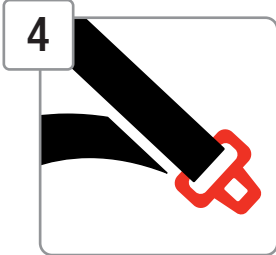

Locking Latch Plate

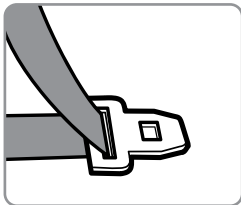

Emergency Locking Retractor with a Sliding Latch Plate

Check Latch Plates

Latch plates are the part of the seat belt that goes into the buckle.

To see if the latch plate locks:

1. Buckle Vehicle Belt
2. Firmly Tug Lap Portion of Seat Belt While Pulling It Up

If the vehicle belt does not slide through the latch plate, it's locked.

If the latch plate slides up and down the vehicle belt, it is a **sliding latch plate**.

Sliding latch plates easily slip between the lap and shoulder portions of the belt.

If you have an Emergency Locking Retractor with a Sliding Latch Plate, you must use a locking clip.

Please contact us for one, see page 57.

Never Use With This Car Seat

Emergency Locking Retractor Lap Only Belt	✗
Inflatable Seat Belts	✗



4-35 lb (1.8-15.9 kg) and 32 in. (81.3 cm) or less in height

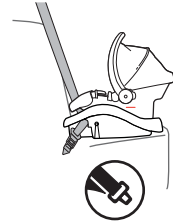

Lap/Shoulder Belt

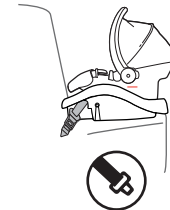

Lap Belt

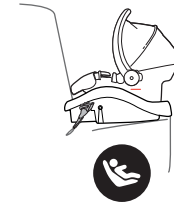

LATCH: Lower Anchor Belt



Never install a rear-facing child restraint in the front seat of a vehicle equipped with an active frontal airbag.

Do not use the lower anchor belt along with the vehicle lap or lap/shoulder belt.

Check the vehicle belt or the lower anchor belt before each use. Use only if the belt can be tightened properly and locked securely in place.

Do not fasten multiple lower anchor hooks on the same lower anchor bar in the vehicle.

The child restraint must be securely attached to the base.

Even when unoccupied, this child restraint must be firmly secured to the vehicle with a lower anchor belt or with the vehicle seat belt.

This child restraint must always face the rear of the vehicle.



Before you begin installing the car seat into your vehicle, did you check:



Your child's weight and height? See page 4.



Your child's fit? See page 6.

Do you need to make adjustments to the harness strap position or the buckle position?

1

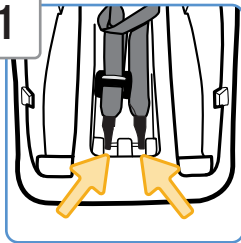

Store Lower Anchor Belt

2

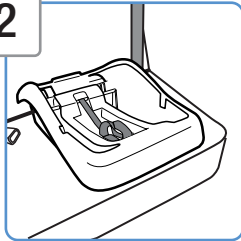

Place Base **Rear-Facing** in Vehicle

Center the base in the chosen seating position.



3

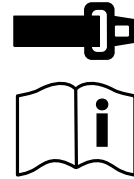

Check if Your Vehicle Belts Will Work With This Car Seat

This is very important because **not all vehicle belts will work with car seats.**

Review pages 24-27 and your vehicle owner's manual to find out what kind of vehicle belts you have and how to lock a car seat in place.

4

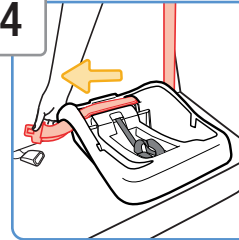

Route Vehicle Lap or Lap/Shoulder Belt Through Base Belt Path

5

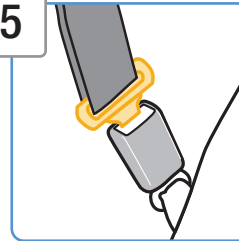

Buckle Vehicle Belt

If your car's vehicle belt has a switchable retractor, use it to lock the vehicle belt.

For information about switchable retractors, see page 26 or review your vehicle owner's manual.

6

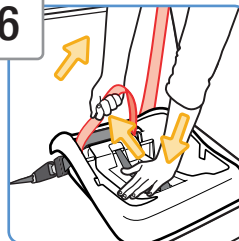

Tighten Belt

Place your hand in the base. Firmly push the base down and back towards the vehicle seat back while pulling the shoulder belt or the free end of the lap belt to tighten.

continued on next page



7

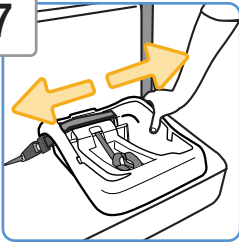

Check Belt Tightness

Hold the base at the **Rear-Facing Belt Path** with your weaker hand.

Push and pull the base from side to side. It should not move more than **1 in.** (2.5 cm).

If it moves more than 1 in. (2.5 cm), you can try:

- Pulling the belt tighter; **OR**
- Reinstalling the base; **OR**
- Changing to a different seating location; **OR**
- Switching to LATCH: lower anchor belt installation if lower anchors are available in your vehicle

8

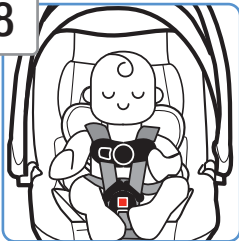

Secure Child in Car Seat

To properly secure your child in the car seat, see pages 19-21.

Check your child's fit often and make any needed adjustments to the car seat as they grow.

9

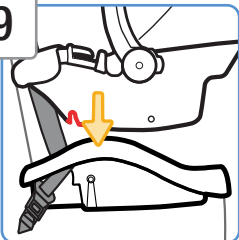

Attach Car Seat to Base

To attach to the base, see page 14.

Pull up on the front two corners of car seat by your child's feet to make sure it is locked to the base.

The carry handle must be upright and locked when installed in the vehicle.



10

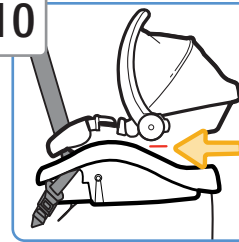

Check Level Line

Redo the installation if the base is not reclined correctly.

Adjust the base if needed, see page 15.

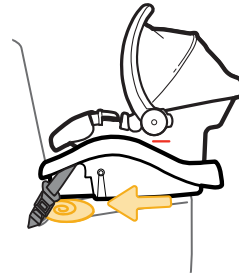

Only if necessary, you may need to place a tightly rolled towel(s) or foam pool noodle(s) under the front of the base to help get the correct recline.

Check often to make sure padding is still in place and the belt is tight.

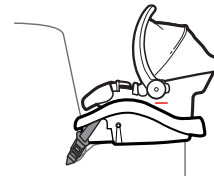

Finished!

Check the tightness of the install often to make sure it has not loosened.



Before you begin installing the car seat into your vehicle, did you check:



Your child's weight and height? See page 4.



Your child's fit? See page 6.

Do you need to make adjustments to the harness strap position or the buckle position?

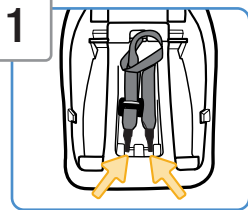

1

Remove Lower Anchor Belt from Storage Attachments

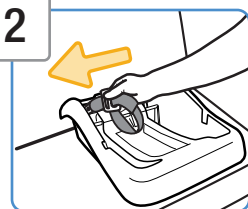

2

Route Lower Anchor Belt Through Base Belt Path

The adjuster can be on either side of the car seat.

Do not twist belt.

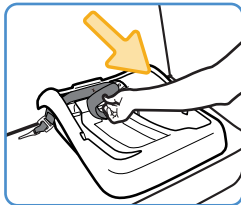

3

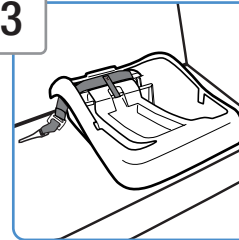

Place Base Rear-Facing in Back Seat

Center the base between the vehicle's lower anchors in the chosen seating position.

4

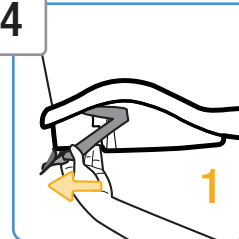

Attach Lower Anchor Hooks to Vehicle's Lower Anchors in Seat Bight

Review your vehicle owner's manual for LATCH: lower anchor locations and lower anchor belt use.

Fasten one hook to one vehicle lower anchor bar.

Then repeat for the second hook on the other side of the base.



2

5

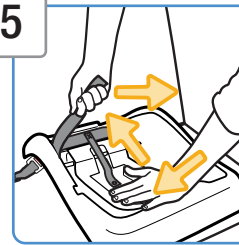

Tighten Belt

Place your hand in the base.

Firmly push the base down and back towards the vehicle seat back while pulling the free end of the belt parallel with the **Rear-Facing Belt Path**.

continued on next page



6

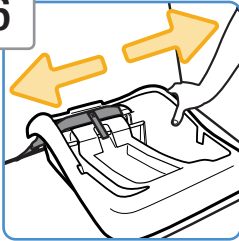

Check Belt Tightness

Hold the base at the **Rear-Facing Belt Path** with your weaker hand.

Push and pull the base from side to side. It should not move more than **1 in. (2.5 cm)**.

If it moves more than 1 in. (2.5 cm), you can try:

- Pulling the belt tighter; **OR**
- Reinstalling the base; **OR**
- Changing to a different seating location; **OR**
- Switching to vehicle belt installation

7

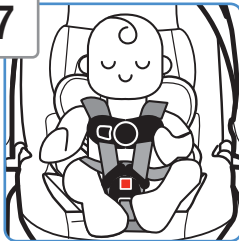

Secure Child in Car Seat

To properly secure your child in the car seat, see pages 19-21.

Check your child's fit often and make any needed adjustments to the car seat as they grow.

8

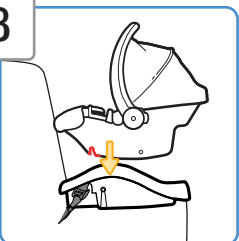

Attach Car Seat to Base

To attach to the base, see page 14.

Pull up on the front two corners of the car seat by your child's feet to make sure it is locked to the base.

The carry handle must be upright and locked when installed in the vehicle.



9

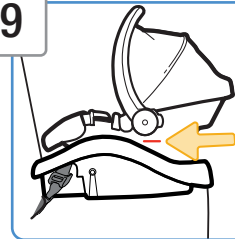

Check Level Line

Redo the installation if the base is not reclined correctly.

Adjust the base if needed, see page 15.

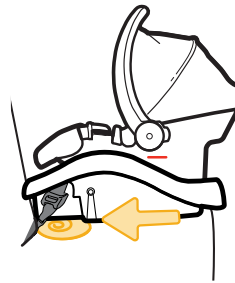

Only if necessary, you may need to place a tightly rolled towel(s) or foam pool noodle(s) under the front of the base to help get the correct recline.

Check often to make sure padding is still in place and the belt is tight.

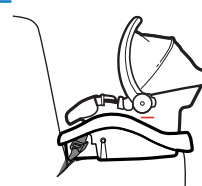

Finished!

Check the tightness of the install often to make sure it has not loosened.



4-35 lb (1.8-15.9 kg) and 32 in. (81.3 cm)
or less in height

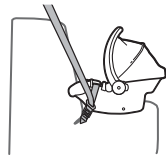

Lap/Shoulder
Belt

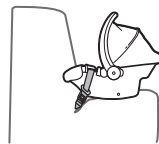

Lap Belt



Never install a rear-facing child restraint in the front seat of a vehicle equipped with an active frontal airbag.

Check the vehicle belt before each use. Use only if the belt can be tightened properly and locked securely in place.

Even when unoccupied, this child restraint must be firmly secured to the vehicle with the vehicle seat belt.

This child restraint must always face the rear of the vehicle.



Before you begin installing the car seat into your vehicle, did you check:

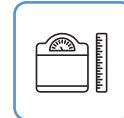

Your child's weight and height? See page 4.



Your child's fit? See page 6.

Do you need to make adjustments to the harness strap position or the buckle position?

1



Secure Child in Car Seat

To properly secure your child in the car seat, see pages 19-21.

Check your child's fit often and make any needed adjustments to the car seat as they grow.

2

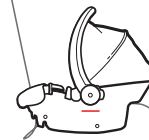

Place Car Seat Rear Facing in Back Seat

Center the car seat in the chosen seating position.

The carry handle must be upright and locked when installed in the vehicle.

3

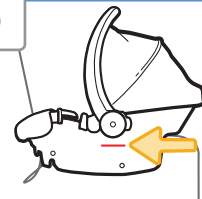

Check Level Line

Adjust if needed.

continued on next page



4

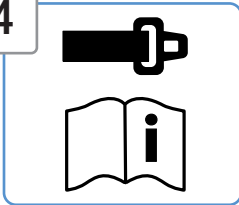

Check if Your Vehicle Belts Will Work With This Car Seat

This is very important because **not all vehicle belts will work with car seats.**

Review pages 24-27 and your vehicle owner's manual to find out what kind of vehicle belts you have and how to lock a car seat in place.

5

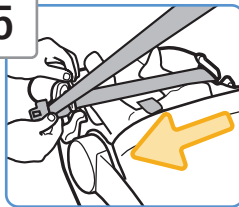

Route Vehicle Lap or Lap/Shoulder Belt Through Shell Belt Path As Shown

6

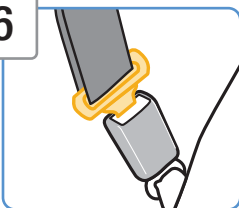

Buckle Vehicle Belt

If your car's vehicle belt has a switchable retractor, use it to lock the vehicle belt.

For information about switchable retractors, see page 26 or review your vehicle owner's manual.

7

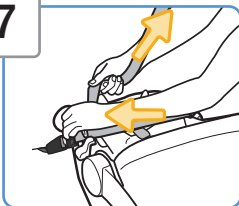

Tighten Vehicle Belt

Lay your forearm across the car seat at the belt path while pulling up on the belt to tighten.



8

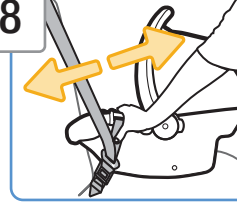

Check Belt Tightness

Hold the car seat at the belt path with your weaker hand.

Push and pull from side to side.

It should not move more than **1 in. (2.5 cm).**

If it moves more than 1 in. (2.5 cm), you can try:

- Pulling the belt tighter; **OR**
- Reinstalling the car seat; **OR**
- Changing to a different seating location

9

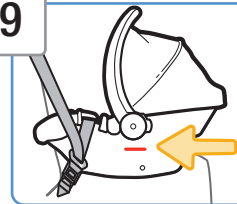

Recheck **Rear-Facing Level Line**

Redo the installation if the car seat is not reclined correctly.

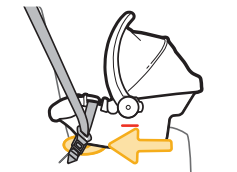

Only if necessary, you may need to place a tightly rolled towel(s) or foam pool noodle(s) under the front of the car seat to help get the correct recline.

Check often to make sure padding is still in place and the belt is tight.

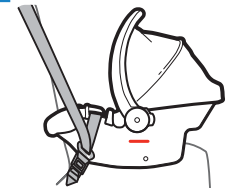

Finished!

Check the tightness of the install often to make sure it has not loosened.

Only remove the harness system to clean the seat pad.
To remove accessories, see page 3.

1

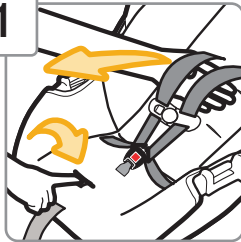

Fully Loosen Harness Straps

2

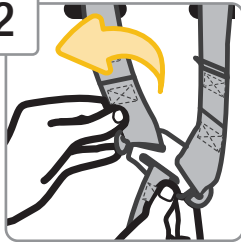

From Back of Car Seat,
Remove Harness Strap
Loops From Splitter Plate

3

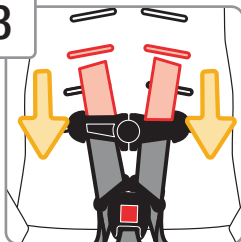

Pull Harness Strap Out
of Shoulder Harness
Slots

4

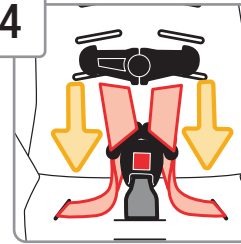

Unthread Chest Clip

5

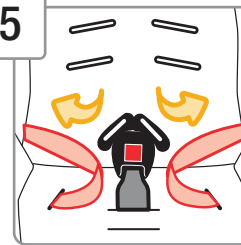

Unthread Buckle
Do not unbuckle.

6

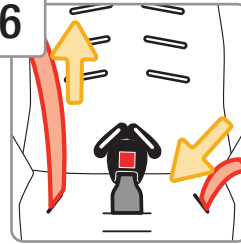

Pull Harness Strap Out
of Seat

7

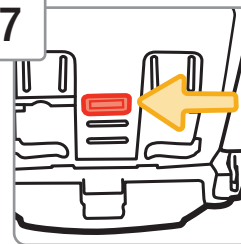

Turn Car Seat Over

Locate the buckle's metal retainer on
the bottom of the shell.

continued on next page

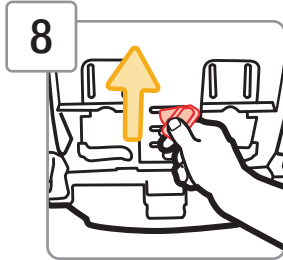

8 Rotate Metal Retainer and Push It Up Through Shell and Pad As Shown



9 From Top of Car Seat, Pull Buckle Out of Shell

You must remove the harness system and the accessories in order to remove the seat pad for cleaning.

To remove accessories, see page 3.

To remove the harness system, see pages 41-43.

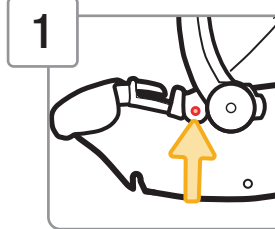

1 Release Pad Tabs

Pull down on the pad and pull the tab out of the shell.

Repeat for the other side.

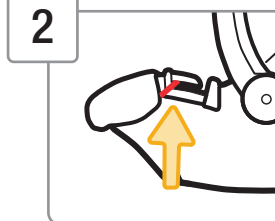
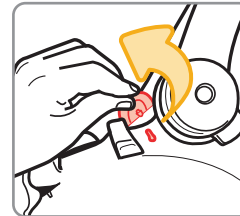

2 Release Elastic Straps

Pull the elastic strap off of the belt path guide as shown.

Repeat for the other side.

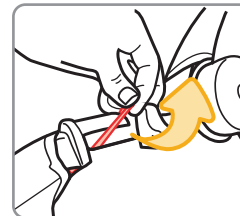

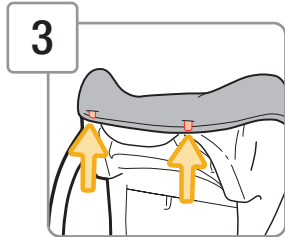

3 Pull Pad off Tabs from Top of Shell

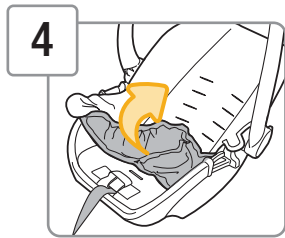

4 Remove Pad from Bottom of Shell

Remove the pad from the shell.

Cleaning Pad and Accessories

Machine wash separately with cold water on a gentle cycle. Do not use bleach. Tumble dry separately for 10-12 minutes on low heat. Remove immediately.

Cleaning Harness Strap

Check the harness straps often for any wear or damage.

Spot clean using warm sudsy water and damp cloth. Spilled food and liquids on the car seat may result in mold or bacterial growth over time. These spills could also attract insects or rodents.

Cleaning Buckle & Car Seat Shell

Spot clean using warm sudsy water and damp cloth. Do not submerge into water.

⚠ Do not use the child restraint without the seat pad or with damaged harness straps.

Installing Seat Pad

Starting from the top of the car seat, slip the pad on the shell. Push the pad tabs at the top of the shell through the slots in the pad.

Pull the harness adjustment strap through the slot in the pad. Wrap the pad around the bottom of the shell.

Attach the tabs on the sides to the shell. Attach the elastic straps to the belt path guides.

Install the harness system. See pages 47-49.



1 Insert Buckle's Metal Retainer into Buckle Slot Closest to Child

The buckle **must** face out.

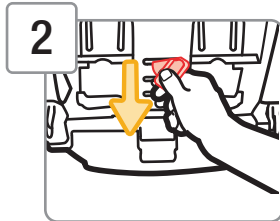

2 From Bottom of Car Seat, Pull Metal Retainer Completely Through Pad and Shell



3 Check Buckle

Pull up on the buckle to make sure it is secured.

The buckle **must not** pull out.

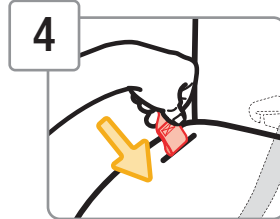

4 Thread Harness Strap

With the sewn end of the harness strap loop facing the buckle, thread the harness strap down through the hip harness slot.

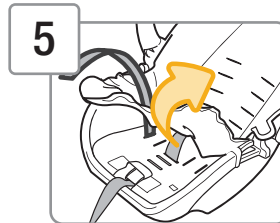

5 Pull Up Front of Seat Pad

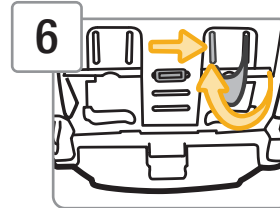

6 Weave Harness Strap In and Out of Shell As Shown

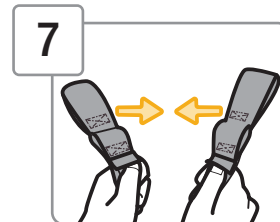
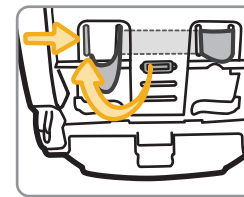
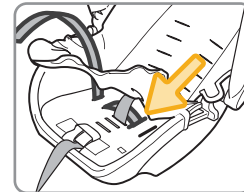

7 Make Harness Strap Even

The sewn ends of the harness strap loops **must** face each other.

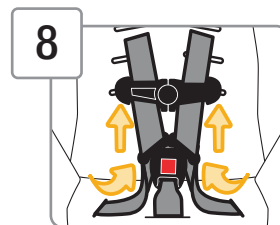

8 Thread Buckle and Chest Clip

The harness strap ends go through the **back** of the buckle on tongues and through the chest clip **front to back** as shown.

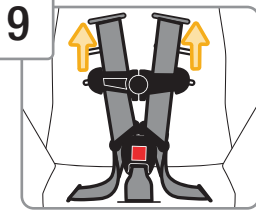

9

Thread Harness Straps into Correct Shoulder Harness Slots for Your Child

For **Rear-Facing Child Fit**, see page 6.

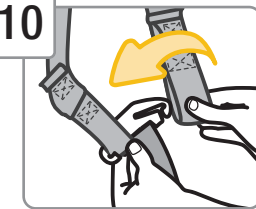

10

From Back of Car Seat, Attach 1st Harness Strap Loops to Splitter Plate As Shown

The sewn ends of the harness strap loops **must** face towards you.

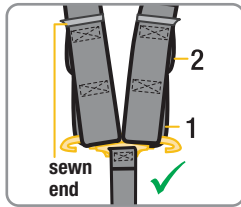

Do not twist the harness strap or the harness adjustment strap.

Make sure the harness strap loops are fitted **completely on** both sides of the splitter plate.

Check your child's fit often.

If you cannot achieve a snug harness fit for your child, see pages 11-13.

To learn how to check harness tightness, see pages 19-21.

Check the harness straps often for any wear or damage.

⚠ The harness system must be installed correctly. Do not use a child restraint with damaged harness straps.



This restraint is certified for aircraft use.

Install the car seat in a window seat to avoid blocking the aisle. If the aircraft lap belt is too short, ask the flight attendant for a belt extender.

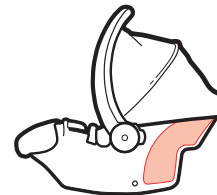

Use only on forward-facing aircraft seats. Contact the airline for their specific policies.

Some airlines may ask to see a label stating that this car seat is certified for aircraft use.

There is an airplane certification label located on the side of this car seat as shown.

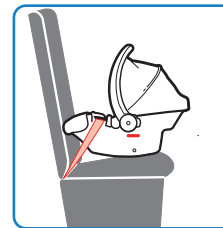

Rear-Facing Aircraft Installation

Follow the steps on pages 38-40.

You can only install this child restraint in the aircraft without the base.

Replacement and Expiration of Car Seat

Do not risk your child's safety.

To keep your child as safe as possible, Dorel Juvenile Group strongly recommends replacing the car seat even after a minor crash; even if it was not occupied at the time.

Replacement After a Minor Crash

The National Highway Traffic Safety Administration states that for a crash to be considered minor **ALL of the following must be true:**

- Vehicle able to drive away from the crash site; **AND**
- Vehicle door nearest the car seat was not damaged; **AND**
- No passengers were injured; **AND**
- Airbags did not deploy; **AND**
- There is no visible damage to the car seat.

If the crash your car seat was involved in meets **ALL** the criteria, you may not need to replace the car seat.

If one or more of these criteria are not true or if you are uncertain of any of your answers, replace the car seat immediately.

Replacement After a Moderate to Severe Crash

You **must** replace this car seat if it has been in a moderate to severe car crash.

This car seat is intended to protect a child in a single crash. During a crash, the car seat and all of its parts absorb crash energy which can deform or weaken it. Damage is not always visible. A damaged car seat must be replaced immediately.

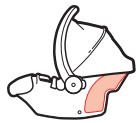

Expiration

On the side of the car seat there is a date of manufacture label as shown.

Do not use this car seat more than 8 years after the date of manufacture.



Child Restraint Use

Never take your child out of the child restraint while the vehicle is moving.

Never leave your child unattended. Placing your child in a hot child restraint may result in burns.

Do not use a child restraint with damaged or missing parts.

Do not use a child restraint with cut, frayed or damaged harnesses.

Do not substitute parts or try to modify the child restraint in any way. Do not lubricate buckles and fasteners.

Do not use any child restraint accessory except those approved by Dorel Juvenile Group.

Never allow any child to play with this child restraint; it is not a toy.

Do not remove or cover up any of the warning labels or other labels on the child restraint.

This child restraint has been certified for use in passenger vehicles. Do not use in a boat, on a motorcycle or in a cargo van or bus where there are no seat belts.

When installing with a base, only use this car seat with a compatible onBoard 35 LT base.

Read all instructions for additional warnings.

Installation in Vehicle

Check the vehicle belt or lower anchor belt before each use. Use only if the belt can be tightened properly and locked securely in place.

Even when unoccupied, this child restraint must be firmly secured to the vehicle with a lower anchor belt or with the vehicle seat belt. In a crash or sudden stop, an unsecured child restraint could injure occupants.



Vehicle Seating Position



Never place a child rear-facing in a seating position with an active frontal air bag.



Check the vehicle owner's manual for more information about air bag/child restraint use.



Use the child restraint only on vehicle seats that face forward.

Do not use on seats that face the sides or rear of the vehicle.

For vehicles without a back seat, refer to your vehicle owner's manual.



Children are safer when properly restrained in rear seating positions than in the front seating positions.

According to accident statistics, children in rear seating positions are statistically safer, whether you have air bags, advanced air bags, or no air bags at all.

If you are not sure where to place the car seat in your vehicle: consult your vehicle owner's manual, contact Dorel Juvenile Group Consumer Care Department or visit your local Child Passenger Inspection Station.

Go to <http://www.safercar.gov/cpsApp/cps/index.htm> to find your closest station.

To avoid your child being seriously burned, take the following precautions:

- Park in the shade or where sun does not directly hit the car seat.
- Cover the car seat with a sheet or blanket when not in use.
- Check for hot seat and buckles before placing child in car seat.

To help protect your vehicle seat's upholstery from damage, use a single layer towel underneath and behind car seat.



Please complete the postage-paid registration card that came with your child restraint, and send it to us. Child restraints could be recalled for safety reasons. You must register this restraint to be reached in a recall. Send your name, address, e-mail address if available and the restraint's model number and manufacturing date to:

Dorel Juvenile Group

2525 State Street
Columbus, IN 47201

or call 1-800-544-1108 or register online at
www.djgusa.com/registration/carseat/us.

For recall information, call the U.S. Government's Vehicle Safety Hotline at 1-888-327-4236 (TTY: 1-800-424-9153), or go to www.NHTSA.gov.

0515079 *Tear Off and Mail This Part or Register Online* 4348-0081D

Consumer: Just fill in your name, address and email. Please print (use dark ink).

Your Name _____

Your Street Address _____

City _____ State _____ Zip Code _____

Email Address (optional) _____

Model Number **AB123CDE**

Model Name **S1 CARSEAT**

Manufacture Date **01/22/2015**



Example of model number, line code, and manufacture date.

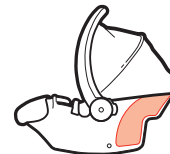

If you don't have the card or if your address changes, you will find the model number, manufacture date, and line code on the label located on side of shell.

Dorel Juvenile Group, Inc. (DJG) warrants this product to the original retail purchaser as follows: This product is warranted against defective materials or workmanship for one year from the date of original purchase.

An original receipt is required to validate your warranty.

DJG will, at its option, provide replacement parts or replace this product. DJG reserves the right to substitute if the part or model has been discontinued.

To make a claim under this warranty, please contact our Consumer Care Department by phone: 1-800-544-1108 or text: 1-812-652-2525. Our hours of operation are from 8:00 a.m. to 6:00 p.m. EST Monday through Thursday and from 8:00 a.m. to 4:30 p.m. on Friday.

Proof of purchase is required and shipping charges are the responsibility of the consumer.

Warranty Limitations: This warranty does not include damages which arise from misuse or abuse of this product.

Limitation of Damages: The warranty and remedies as set forth are exclusive and in lieu of all others, oral or written, expressed or implied. In no event will DJG or the dealer selling this product be liable to you for any damages, including incidental or consequential damages, arising out of the use or inability to use this product.

Limitation of warranties and other warranty terms and state law rights: Any implied warranties, including implied warranties of the merchantability and fitness for a particular purpose, shall be limited to the duration and terms of the express written warranty.

Some states do not allow limitations as to how long an implied warranty lasts or the exclusion or limitation of incidental or consequential damages, so the above limitations may not apply to you.

This warranty gives you specific legal rights, and you may have other rights, which vary from state to state. Neither DJG nor the dealer selling this product authorized any person to create for it any other warranty, obligation, or liability in connection with this product.

1. If the car seat's buckle or harness release lever sticks or you cannot get the straps tight enough around your child:

Do not lubricate. Check around the lever and the retractor for dropped food, sticky spilled drinks, dirt, leaves, etc. Clean with warm water and/or remove the object with tweezers. If you cannot get the harness to adjust and remain tight with the buckle securely locked, **do not** use this car seat.

2. If your harness twists:

Straighten the harness each time you put your child in the car seat to help prevent twisting. Lock the buckle and tighten the harness so it will be ready for next use.

Chest Clip	Lower Anchor Belt
Buckle Assembly	Harness Straps
Seat Pad Set	Instructions
Base	Locking Clip

**If requested color is not available,
similar color will be substituted.**

**Applicable tax and shipping &
handling will also be added.**

For parts availability and questions,

Call: 1-800-544-1108

Text: 1-812-652-2525

Chat: www.safety1st.com

If you already know which parts you need,
you may complete your order with a credit card
by calling us at 1-800-544-1108.

We accept Visa or MasterCard.

Hours of Operation:

M-TH: 8:00 AM - 6:00 PM EST

FRI: 8:00 AM - 4:30 PM EST

Thank you for choosing this car seat, also known as a child restraint. The DJG family is committed to creating car seats with the most comfort and convenience available today.

Remember, parents are a child's first teachers and examples. If you always buckle your seat belt, your child will think it is the natural thing to do. Make it a firm rule that the vehicle does not go until everyone is buckled up. Make no exceptions.

No one can predict if use of a car seat will prevent injury or death in a particular crash. However, when combined with careful driving, proper use of a car seat can lower a child's risk of injury or death in most crashes.

If you have questions or any concerns with this car seat, please contact our Consumer Care Department:

Call: 1-800-544-1108

Text: 1-812-652-2525

Website: www.safety1st.com

Hours of Operation:

M-TH: 8:00 AM - 6:00 PM EST

FRI: 8:00 AM - 4:30 PM EST